



CL.1 Wall valve clockwise closing cold 1/2" - Brushed Platinum

36 627 706 Product version from 10/14/2020

mm [inches]



Codes & Standards

ASME A112.18.1	cUPC	DIN 4109	EN 200
ISO 3822	Scottish Water Byelaws	UK Water Supply Regulations	Ü-Zeichen

Certificates

DVGW_DW-6501DN0	LGA_29	WRAS_2010	LGA_29	IAPMO_4976 (
-----------------	--------	-----------	--------	--------------

CL.1 Wall valve clockwise closing cold 1/2" - Brushed Platinum

36 627 706 Product version from 10/14/2020

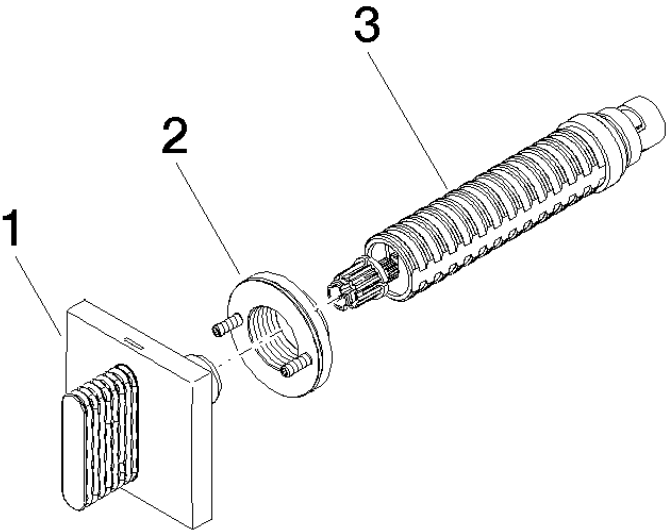

Spare parts list

No.	Item Number	Name	Quantity used	Delivery time
1	90 20 70 053 02-06	handle (cold)	1	10
2	90 21 02 108 00 90	disc	1	2
3	90 90 03 143 00 90	top	1	2