



CL.1 Wall valve anti-clockwise closing hot 1/2" - Chrome

CL.1

36 627 707



- with CASCADE structure
- rosette 60 x 60 mm
- with hot marking
- head part with cut-to-length spindle and sleeve
- WRAS 2010066

	Chrome	36 627 707-00
	Brushed Platinum	36 627 707-06
	Dark Chrome	36 627 707-19
	Brushed Champagne (22kt Gold)	36 627 707-46
	Champagne (22kt Gold)	36 627 707-47
	Brushed Dark Platinum	36 627 707-99

Required miscellaneous



- Wall valve 1/2" -

•max. recess depth 150 mm

•min. recess depth 105 mm

35 607 970 90



CL.1 Wall valve anti-clockwise closing hot 1/2" - Chrome

CL.1

36 627 707

mm [inches]

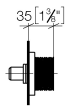

Codes & Standards

ASME A112.18.1	cUPC	DIN 4109	EN 200
ISO 3822	Scottish Water Byelaws	UK Water Supply Regulations	Ü-Zeichen

Certificates

IAPMO_4976	DVGW_DW-6501DN0	WRAS_2010	LGA_29	LGA_29
------------	-----------------	-----------	--------	--------

36 627 707

Product version up to 10/14/2020

**Product version from 10/14/2020**

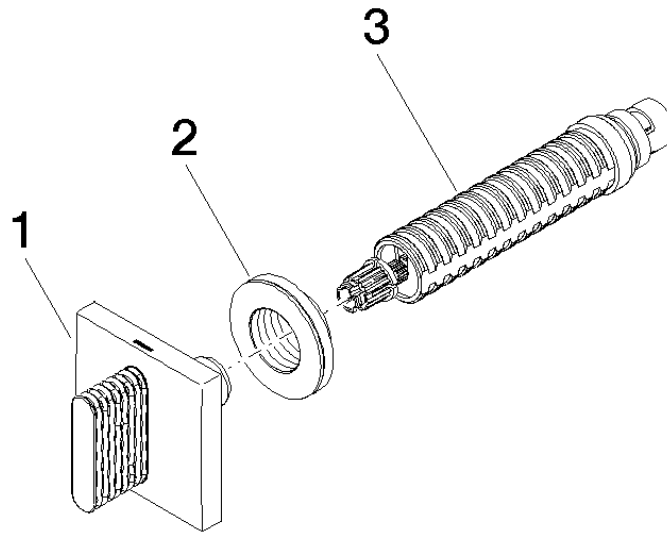



## CL.1 Wall valve anti-clockwise closing hot 1/2" - Chrome

CL.1

36 627 707

### Spare parts list

Product version up to 10/14/2020

#### Product version from 10/14/2020

No.	Item Number	Name	Quantity used	Delivery time
	90 20 70 053 03-00	handle ( hot )	3	10