







CL.1 Wall valve anti-clockwise closing hot 1/2" - Brushed Platinum

36 627 707    Product version from 10/14/2020



- with CASCADE structure
- rosette 60 x 60 mm
- with hot marking
- head part with cut-to-length spindle and sleeve
- WRAS

	Brushed Platinum	36 627 707-06
	Chrome	36 627 707-00
	Dark Chrome	36 627 707-19
	Brushed Champagne (22kt Gold)	36 627 707-46
	Champagne (22kt Gold)	36 627 707-47
	Brushed Dark Platinum	36 627 707-99

Required miscellaneous

	<div> <div>Wall valve 1/2" -</div> <div> <div>•max. recess depth mm</div> <div>•min. recess depth mm</div> </div> </div>	35 607 970 90
---	--	---------------



# CL.1 Wall valve anti-clockwise closing hot 1/2" - Brushed Platinum

36 627 707    Product version from 10/14/2020

mm [inches]



## Codes & Standards

ASME A112.18.1	cUPC	DIN 4109	EN 200
ISO 3822	Scottish Water Byelaws	UK Water Supply Regulations	Ü-Zeichen

## Certificates

DVGW_DW-6501DN0	LGA_29	WRAS_2010	LGA_29	IAPMO_4976 (
-----------------	--------	-----------	--------	--------------

CL.1 Wall valve anti-clockwise closing hot 1/2" - Brushed Platinum

36 627 707    Product version from 10/14/2020

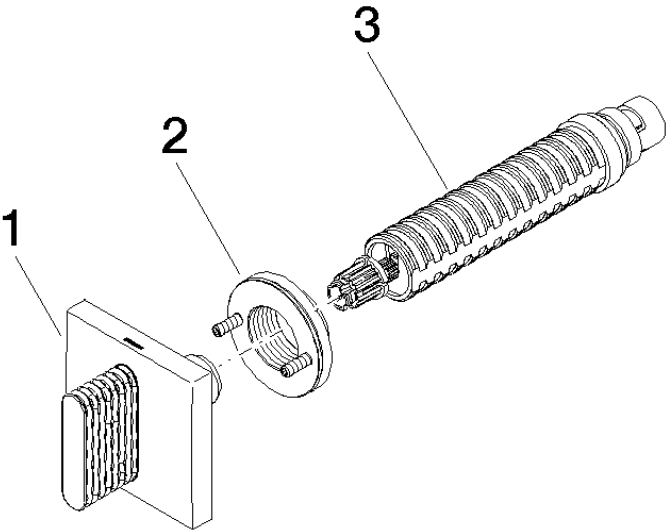

Spare parts list

No.	Item Number	Name	Quantity used	Delivery time
1	90 20 70 053 03-06	handle ( hot )	1	10
2	90 21 02 108 00 90	disc	1	2
3	90 90 03 142 00 90	top	1	2