

ST 060 101 1710



- cover plate 120 x 120 mm
- rosette 78 x 55 mm
- temperature control handle with safety limit stop at 38°C

Individual components of this set

You need the following components for this set



1x 36 416 710-00

ST 060 101 1710



- cover plate 120 x 120 mm
- temperature control handle with safety limit stop at 38°C

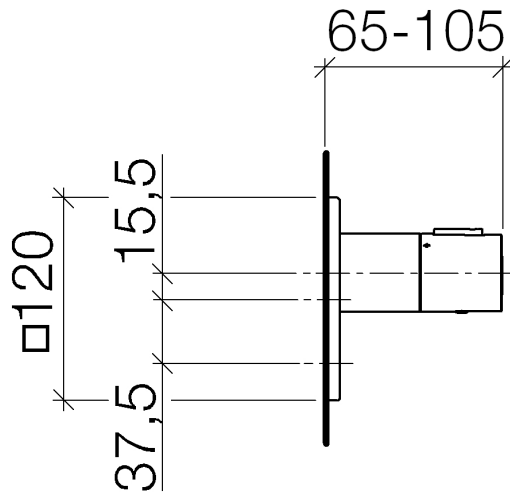

Certificates

IAPMO_4976

Codes & Standards

ASME A112.18.1 cUPC

ST 060 101 1710

Product version up to 2/2/2021

Product version from 1/1/2022

Product version from 6/30/2022 to 11/25/2021

Product version from 9/1/2022

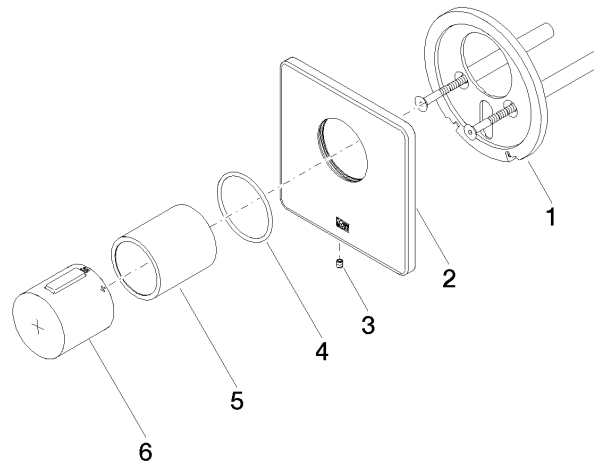



LULU xTOOL Thermostat module with 3 valves - Chrome

LULU

ST 060 101 1710

Spare parts list

Product version up to 2/2/2021

Product version from 1/1/2022

Product version from 6/30/2022 to 11/25/2021

Product version from 9/1/2022

No.	Item Number	Name	Quantity used	Delivery time
	90 11 01 196 00 90	base	6	2