

CL.1 xTOOL Thermostat module with 1 valve - Chrome

CL.1

ST 060 108 6705



- cover plate 120 x 120 mm
  - rosette 60 x 60 mm
  - temperature control handle with safety limit stop at 38°C
  - thermostat cartridge
  - head part with cut-to-length spindle and sleeve
- 36 501 985-FF can also be used as an alternative.**

	Chrome	ST 060 108 6705-00
	Brushed Platinum	ST 060 108 6705-06
	Brushed Champagne (22kt Gold)	ST 060 108 6705-46
	Champagne (22kt Gold)	ST 060 108 6705-47
	Brushed Dark Platinum	ST 060 108 6705-99

Individual components of this set

You need the following components for this set



1x 36 501 780-00







1x 36 607 705-00

ST 060 108 6705

Error: Subreport could not be shown.

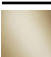

- rosette 60 x 60 mm
- without marking
- head part with cut-to-length spindle and sleeve
- WRAS 2011026, 2010066

	Chrome	36 607 705-0
	Brushed Platinum	36 607 705-0
	Dark Chrome	36 607 705-1
	Brushed Champagne (22kt Gold)	36 607 705-4
	Champagne (22kt Gold)	36 607 705-4
	Brushed Dark Platinum	36 607 705-9

ST 060 108 6705

10  
—  
16  
—  
9  
—  
6  
—  
7  
—  
9  
—

Required miscellaneous



- Wall valve 1/2" -**  
•max. recess depth 150 mm  
•min. recess depth 105 mm

35 607 970 90

ST 060 108 6705

mm [inches]



Certificates

IAPMO_4976	DVGW_DW-6501DN0	WRAS_2010	LGA_29	LGA_29
DVGW_DW-6512DN0	WRAS_2011			

Codes & Standards

ASME A112.18.1	cUPC	DIN 4109	EN 1111
EN 200	ISO 3822	Scottish Water Byelaws	UK Water Supply Regulations

Ü-Zeichen

Product version up to 10/14/2020

**Product version from 10/14/2020**

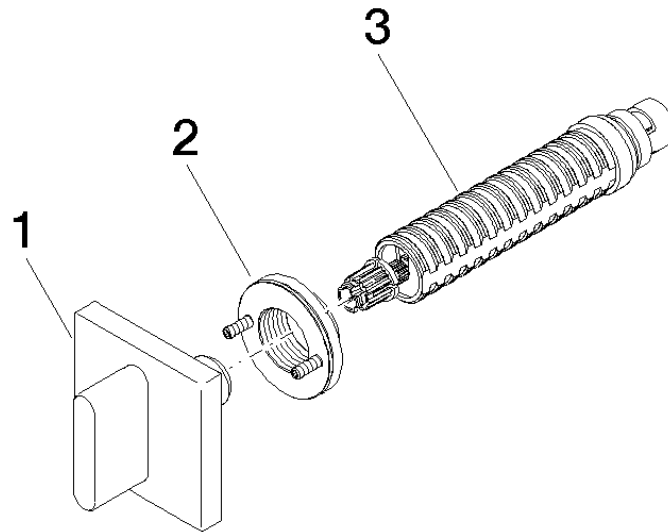

ST 060 108 6705

Spare parts list

Product version up to 10/14/2020

**Product version from 10/14/2020**

No.	Item Number	Name	Quantity used	Delivery time
	90 20 70 051 01-00	handle	3	10