



VAIA Two-hole bridge mixer with rinsing spray set - Brushed Chrome

VAIA

ST 110 202 6809



- 241mm projection
- pivotable spout 360°
- air-enriched flow and spray flow
- fabric braided hose 1500 mm
- automatic spout/shower diverter
- sprayface with anti-scaling system
- max. flow 7 l/min at 3 bar flow pressure
- lead-free
- This product can help a building meet the requirements of Green Building Rating Systems, e.g. LEED®, BREEAM®, DGNB

|  |                               |                    |
|--|-------------------------------|--------------------|
|  | Brushed Chrome                | ST 110 202 6809-93 |
|  | Chrome                        | ST 110 202 6809-00 |
|  | Brushed Platinum              | ST 110 202 6809-06 |
|  | Platinum                      | ST 110 202 6809-08 |
|  | Durabrand (23kt Gold)         | ST 110 202 6809-09 |
|  | Dark Chrome                   | ST 110 202 6809-19 |
|  | Brushed Durabrand (23kt Gold) | ST 110 202 6809-28 |
|  | Matte Black                   | ST 110 202 6809-33 |
|  | Brushed Champagne (22kt Gold) | ST 110 202 6809-46 |
|  | Champagne (22kt Gold)         | ST 110 202 6809-47 |
|  | Brushed Dark Platinum         | ST 110 202 6809-99 |

Individual components of this set

You need the following components for this set



1x 19 815 809-93



1x 27 731 809-93









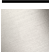

# VAIA Two-hole bridge mixer with rinsing spray set - Brushed Chrome

VAIA

ST 110 202 6809



- 241mm projection
- pivotable spout 360°
- air-enriched flow
- max. flow 7 l/min at 3 bar flow pressure
- lead-free
- This product can help a building meet the requirements of Green Building Rating Systems, e.g. LEED®, BREEAM®, DGNB

|  |                               |              |
|--|-------------------------------|--------------|
|  | Brushed Chrome                | 19 815 809-9 |
|  | Chrome                        | 19 815 809-0 |
|  | Brushed Platinum              | 19 815 809-0 |
|  | Platinum                      | 19 815 809-0 |
|  | Durabrand (23kt Gold)         | 19 815 809-0 |
|  | Dark Chrome                   | 19 815 809-1 |
|  | Brushed Durabrand (23kt Gold) | 19 815 809-2 |
|  | Matte Black                   | 19 815 809-3 |
|  | Brushed Champagne (22kt Gold) | 19 815 809-4 |
|  | Champagne (22kt Gold)         | 19 815 809-4 |
|  | Brushed Dark Platinum         | 19 815 809-9 |

ST 110 202 6809

3  
—  
0  
—  
6  
—  
8  
—  
9  
—  
9  
—  
8  
—  
3  
—  
6  
—  
7  
—  
9  
—

Recommended miscellaneous

**VAIA Dispenser with rosette -** 82 434 809-93  
**Brushed Chrome**



ST 110 202 6809

mm [inches]  
1:5

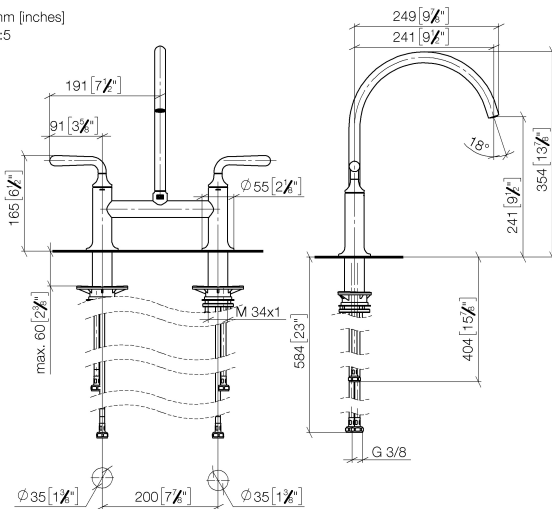

### Flow rate chart

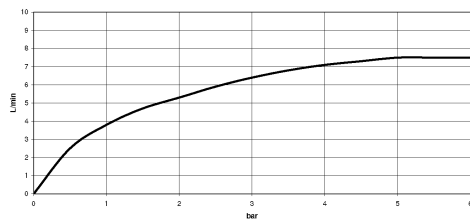

### Certificates

LGA\_38



VAIA Two-hole bridge mixer with rinsing spray set - Brushed Chrome

VAIA

ST 110 202 6809

Codes & Standards

|          |          |           |
|----------|----------|-----------|
| DIN 4109 | ISO 3822 | Ü-Zeichen |
|----------|----------|-----------|



**Product version from 7/1/2023**

Parts for other  
finishes can be found  
here: [Chrome](#)

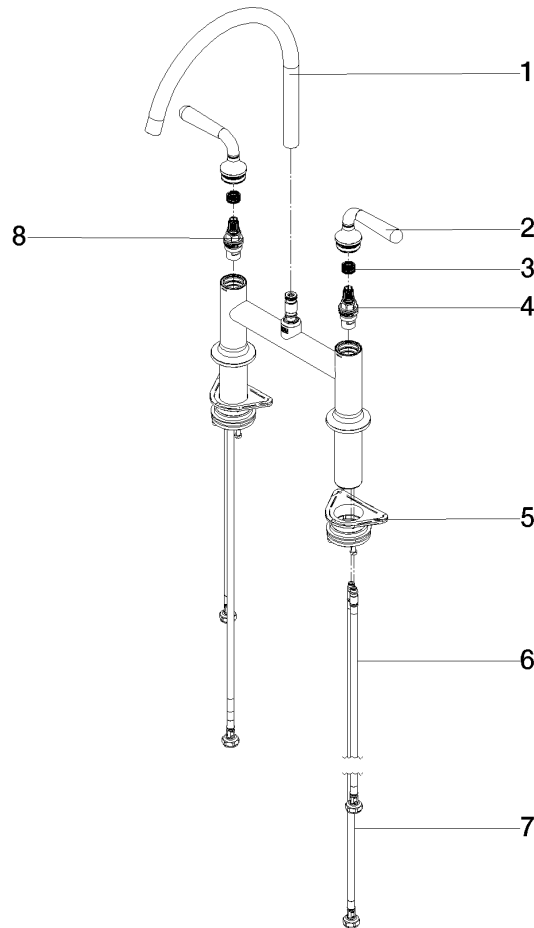



VAIA Two-hole bridge mixer with rinsing spray set - Brushed Chrome

VAIA

ST 110 202 6809

**Spare parts list**

**Product version from 7/1/2023**

| No. | Item Number        | Name  | Quantity used | Delivery time |
|-----|--------------------|-------|---------------|---------------|
|     | 90 28 22 396 00-93 | spout | 13            | 60            |

## VAIA Two-hole bridge mixer with rinsing spray set - Brushed Chrome

VAIA

ST 110 202 6809



- with round rosette
- spray flow
- automatic spout/shower diverter
- height of mixer 202 mm
- hole diameter rinsing spray 32mm
- fabric braided hose 1500 mm
- sprayface with anti-scaling system
- lead-free

Can only be combined with 33810809, 33826809, 19815809, 19825809.

Intrinsic protection against back flow.

Residual water may emerge from the spray after closing.

Operating unit can be positioned freely.

|  |                               |              |
|--|-------------------------------|--------------|
|  | Brushed Chrome                | 27 731 809-9 |
|  | Chrome                        | 27 731 809-0 |
|  | Brushed Platinum              | 27 731 809-0 |
|  | Platinum                      | 27 731 809-0 |
|  | Durabrand (23kt Gold)         | 27 731 809-0 |
|  | Dark Chrome                   | 27 731 809-1 |
|  | Brushed Durabrand (23kt Gold) | 27 731 809-2 |
|  | Matte Black                   | 27 731 809-3 |
|  | Brushed Champagne (22kt Gold) | 27 731 809-4 |
|  | Champagne (22kt Gold)         | 27 731 809-4 |
|  | Brushed Dark Platinum         | 27 731 809-9 |



VAIA Two-hole bridge mixer with rinsing spray set - Brushed Chrome

VAIA

ST 110 202 6809

3  
—  
0  
—  
6  
—  
8  
—  
9  
—  
9  
—  
8  
—  
3  
—  
6  
—  
7  
—  
9  
—

ST 110 202 6809

mm [inches]

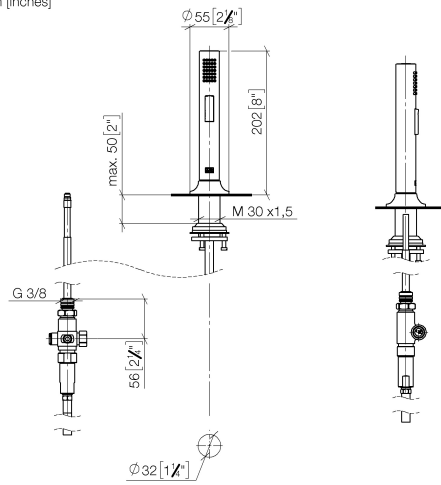

## Certificates

Belgaqua\_24-005-2

#### Codes & Standards

EN 1717



## Spare parts list