

ELIO HOT & COLD WATER DISPENSER - Brushed Dark Platinum

ELIO

17 861 790 Product version from 3/9/2016 to 5/27/2021



- 142mm projection
- rigid, thermally insulated spout
- laminar flow
- height of mixer 248 mm
- height up to laminar flow regulator 226 mm
- hole diameter 35 mm
- provides filtered, hot water up to 93°C
- provides filtered, cold water
- max. flow 2 l/min at 3 bar flow pressure
- ready-to-use control unit for wall mounting (137mm x 159mm x 60mm)
- electronic magnetic valve
- 100-230 V, 50-60 Hz, 18 W power supply unit, incl. country-specific adapter set
- lead-free

• Spout ring cannot be removed.

• This product can help a building meet the requirements of Green Building Rating Systems, e.g. LEED®, BREEAM®, DGNB

A minimum flow pressure of 3 bar is necessary for the HOT & COLD WATER DISPENSER to work perfectly in conjunction with a hot water tank and filter.

The installation must be above a kitchen sink.

The filter cartridge must be changed every six months. The installation instructions contain further information for guidance.

Detailed planning information and technical data can be found at

www.dornbracht.com/professional

A minimum flow pressure of 3 bar is necessary for the HOT & COLD WATER DISPENSER to work perfectly in conjunction with a hot water tank and filter.

The installation must be above a kitchen sink.

The filter cartridge must be changed every six months. The installation instructions contain further information for guidance.

Detailed planning information and technical data can be found at www.dornbracht.com/professional

| | | |
|---|--------------------------------|---------------|
|  | Brushed Dark Platinum | 17 861 790-99 |
|  | Chrome | 17 861 790-00 |
|  | Brushed Platinum | 17 861 790-06 |
|  | Platinum | 17 861 790-08 |
|  | Dark Chrome | 17 861 790-19 |
|  | Brushed Durabronze (23kt Gold) | 17 861 790-28 |
|  | Brushed Champagne (22kt Gold) | 17 861 790-46 |
|  | Champagne (22kt Gold) | 17 861 790-47 |
|  | Brushed Chrome | 17 861 790-93 |

Required miscellaneous



Hot water tank incl. filter -

12 892 970 90

17 861 790 Product version from 3/9/2016 to 5/27/2021

mm [inches]

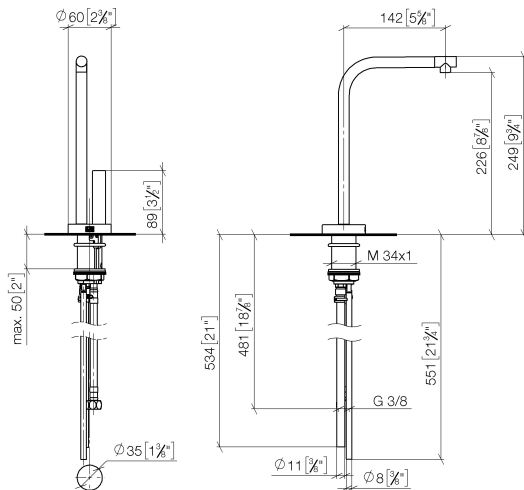

Flow rate chart

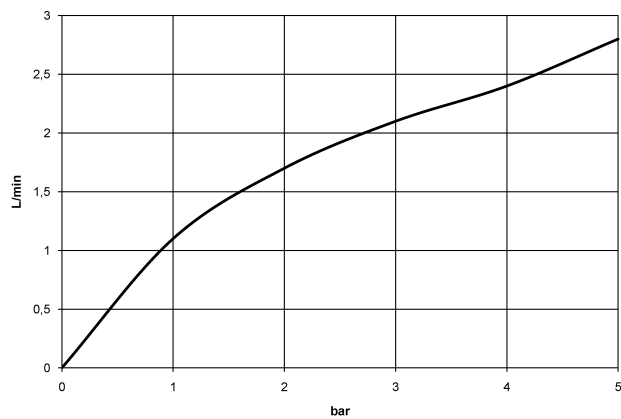

Codes & Standards

| | | | |
|----------------|-------|-----------|----------|
| ASME A112.18.1 | cUPC | DIN 4109 | ISO 3822 |
| NSF372 | NSF61 | Ü-Zeichen | |



ELIO HOT & COLD WATER DISPENSER - Brushed Dark Platinum

ELIO

17 861 790 Product version from 3/9/2016 to 5/27/2021

Certificates and sustainability

| | | | |
|-----------|------------|--------|---------|
| IAPMO_N-4 | IAPMO_4976 | LGA_28 | IAPMO_6 |
|-----------|------------|--------|---------|

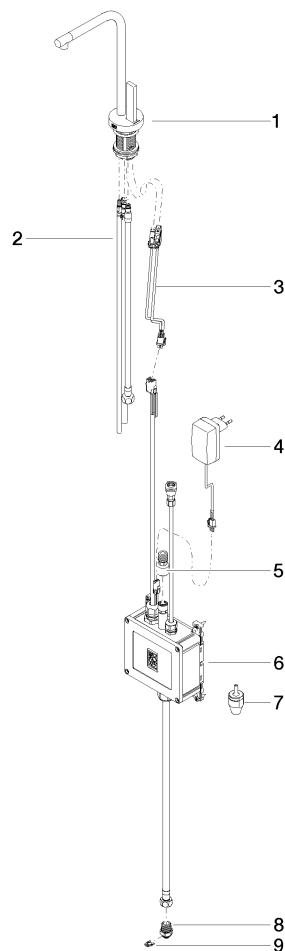

Spare parts list

| No. | Item Number | Name | Quantity used | Delivery time |
|-----|----------------------|-------------------------------------|---------------|---------------|
| | 2 90 30 04 067 00 90 | hose | 1.00 | 2 |
| | 3 90 10 01 048 00 90 | electronic accessories | 1.00 | 2 |
| | 9 09 16 01 045 90 | ring | 1.00 | 2 |
| | 8 09 24 04 293 90 | nipple | 1.00 | 2 |
| | 5 12 866 970 90 | Adapter Flow restrictor HCWD 3/8" - | 1.00 | 2 |
| | 1 90 17 85 100 04-99 | fitting | 1.00 | 20 |
| | 4 04 10 01 246 00 90 | electronic accessories | 1.00 | 2 |
| | 7 90 24 04 291 00 90 | insert | 1.00 | 2 |
| | 6 90 11 11 064 01 90 | electronic accessories | 1.00 | 2 |