

TARA Deck valve clockwise closing cold or hot - Brushed Champagne (22kt Gold)
TARA

20 000 892
Product version from 4/1/2025



- hole diameter 32 mm
- rosette Ø 55 mm
- WRAS

	Brushed Champagne (22kt Gold)	20 000 892-46
	Chrome	20 000 892-00
	Brushed Platinum	20 000 892-06
	Platinum	20 000 892-08
	Dark Chrome	20 000 892-19
	Brushed Durabronze (23kt Gold)	20 000 892-28
	Matte Black	20 000 892-33
	Brushed Dark Brass	20 000 892-39
	Brushed Bronze	20 000 892-42
	Champagne (22kt Gold)	20 000 892-47
	Brushed Chrome	20 000 892-93
	Brushed Dark Platinum	20 000 892-99

TARA Deck valve clockwise closing cold or hot - Brushed Champagne (22kt Gold)

TARA

20 000 892 Product version from 4/1/2025
mm [inches]

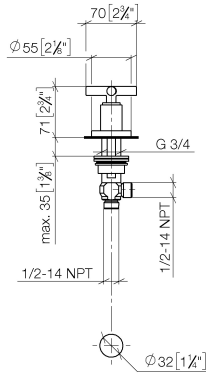

Flow rate chart



Codes & Standards

ASME A112.18.1	cUPC	Scottish Water Byelaws	UK Water Supply Regulations
----------------	------	---------------------------	--------------------------------



TARA Deck valve clockwise closing cold or hot - Brushed Champagne (22kt Gold)

TARA

20 000 892 Product version from 4/1/2025

Certificates and sustainability

WRAS_2112

IAPMO_4976

This exploded view diagram illustrates the assembly of a water filter. The components are numbered as follows:

- 1**: The main housing, which includes the top cap (2), the filter body (3), and the bottom cap (7).
- 2**: The top cap, which fits onto the housing.
- 3**: The filter body, which contains the filter media (4) and is secured by the top cap (2) and bottom cap (7).
- 4**: The filter media, which is the core of the filter.
- 5**: A screw that secures the filter media (4) within the filter body (3).
- 6**: A gasket or O-ring that seals the filter body (3) to the bottom cap (7).
- 7**: The bottom cap, which completes the housing and seals the filter body (3).
- 8**: A gasket or O-ring that seals the bottom cap (7) to the housing.
- 9**: The inlet/outlet fitting, which is attached to the bottom of the housing.

4/4 5/16/2025