

# Shower set without hand shower - Brushed Dark Platinum

SERIES SPECIFIC

26 413 625    Product version from 10/1/2023



- slide bar
- Pipe diameter 18 mm
- rosette Ø 55 mm
- gauge 800 mm
- metal shower hose 1750mm with integrated anti-twist protection
- shower hose connector 3/8"
- WRAS

This article does not include a hand shower!

|   |                               |               |
|---|-------------------------------|---------------|
|    | Brushed Dark Platinum         | 26 413 625-99 |
|    | Chrome                        | 26 413 625-00 |
|    | Brushed Platinum              | 26 413 625-06 |
|    | Platinum                      | 26 413 625-08 |
|    | Dark Chrome                   | 26 413 625-19 |
|    | Light Gold                    | 26 413 625-26 |
|    | Brushed Light Gold            | 26 413 625-27 |
|    | Brushed Durabrass (23kt Gold) | 26 413 625-28 |
|    | Matte Black                   | 26 413 625-33 |
|   | Brushed Bronze                | 26 413 625-42 |
|  | Brushed Champagne (22kt Gold) | 26 413 625-46 |
|  | Champagne (22kt Gold)         | 26 413 625-47 |
|  | Brushed Chrome                | 26 413 625-93 |

## Shower set without hand shower - Brushed Dark Platinum

SERIES SPECIFIC

26 413 625 Product version from 10/1/2023

### Recommended miscellaneous

|   |  |               |
|---|--|---------------|
|  | <b>Concealed wall elbow -</b><br>• max. recess depth 163 mm<br>• min. recess depth 90 mm | 35 085 970 90 |
|---|--|---------------|

### Required miscellaneous

|   |  |               |
|---|--|---------------|
|  | <b>Hand shower - Brushed Dark Platinum</b> | 28 018 979-99 |
|---|--|---------------|

### Recommended miscellaneous

|   |   |               |
|---|---|---------------|
|  | <b>Wall elbow - Brushed Dark Platinum</b> | 28 450 625-99 |
|---|---|---------------|

### Required miscellaneous

|   |   |                    |
|---|---|--------------------|
|  | <b>Hand shower FlowReduce - Brushed Dark Platinum</b> | 28 012 979-99 0010 |
|---|---|--------------------|

### Required miscellaneous

|   |   |                    |
|---|---|--------------------|
|  | <b>Hand shower FlowReduce - Brushed Dark Platinum</b> | 28 018 979-99 0010 |
|---|---|--------------------|

### Required miscellaneous

|   |   |               |
|---|---|---------------|
|  | <b>SERIES-VARIOUS Hand shower - Brushed Dark Platinum</b> | 28 029 979-99 |
|---|---|---------------|

### Required miscellaneous

|   |  |                    |
|---|--|--------------------|
|  | <b>SERIES-VARIOUS Hand shower FlowReduce - Brushed Dark Platinum</b> | 28 025 979-99 0010 |
|---|--|--------------------|

### Required miscellaneous

|   |   |                    |
|---|---|--------------------|
|  | <b>Hand shower FlowReduce - Brushed Dark Platinum</b> | 28 016 979-99 0010 |
|---|---|--------------------|

### Required miscellaneous

|   |  |               |
|---|--|---------------|
|  | <b>Hand shower - Brushed Dark Platinum</b> | 28 012 979-99 |
|---|--|---------------|

### Required miscellaneous

|   |  |               |
|---|--|---------------|
|  | <b>Hand shower - Brushed Dark Platinum</b> | 28 016 979-99 |
|---|--|---------------|

### Required miscellaneous

|   |  |               |
|---|--|---------------|
|  | <b>Hand shower - Brushed Dark Platinum</b> | 28 017 979-99 |
|---|--|---------------|

### Required miscellaneous

|   |  |                    |
|---|--|--------------------|
|  | <b>SERIES-VARIOUS Hand shower FlowReduce - Brushed Dark Platinum</b> | 28 027 979-99 0010 |
|---|--|--------------------|

### Required miscellaneous

|   |  |                    |
|---|--|--------------------|
|  | <b>SERIES-VARIOUS Hand shower FlowReduce - Brushed Dark Platinum</b> | 28 029 979-99 0010 |
|---|--|--------------------|

26 413 625    Product version from 10/1/2023



| Codes & Standards |      |                        |                             |
|-------------------|------|------------------------|-----------------------------|
| ASME A112.18.1    | cUPC | Scottish Water Byelaws | UK Water Supply Regulations |
| XP P 41-280       |      |                        |                             |

| Certificates and sustainability |               |            |
|---------------------------------|---------------|------------|
| WRAS_2009                       | ACS_20 ACC LY | IAPMO_4976 |

## Shower set without hand shower - Brushed Dark Platinum

SERIES SPECIFIC

26 413 625 Product version from 10/1/2023

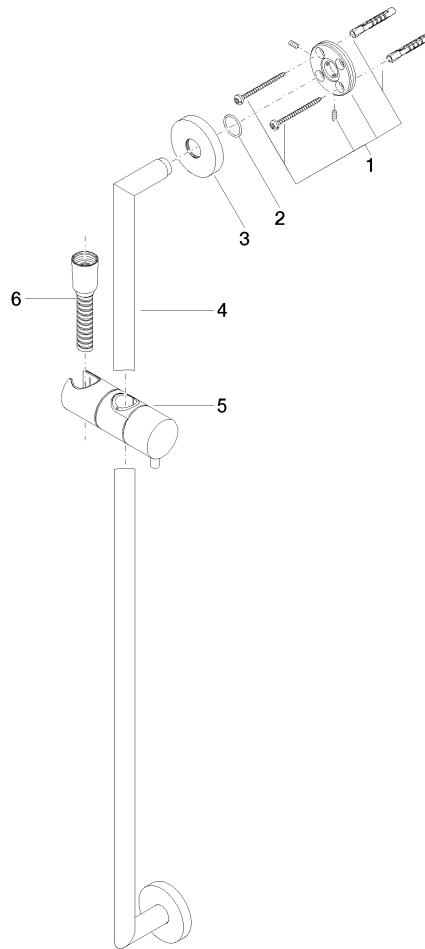

### Spare parts list

| No. | Item Number        | Name  | Quantity used | Delivery time |
|-----|--------------------|---|---------------|---------------|
| 3   | 08 27 62 500-99    | rosette   | 2.00          | 20            |
| 6   | 28 322 970-99      | Metal shower hose 1/2" x 3/8" x 1750 mm - Brushed Dark Platinum | 1.00          | 2             |
| 5   | 12 580 970-99      | Slide unit - Brushed Dark Platinum                              | 1.00          | 20            |
| 1   | 05 17 62 500 00 90 | fixing set  | 2.00          | 2             |
| 4   | 05 28 22 590 01-99 | bar   | 1.00          | 20            |
| 2   | 90 14 10 032 00 90 | seal  | 2.00          | 2             |