

VAIA Five-hole bath mixer for deck mounting with diverter - Brushed Bronze

VAIA

27 522 819 Product version from 3/13/2017



- spout: circular, air-enriched flow
- max. flow 21.5 l/min at 3 bar flow pressure
- Hand shower: COMPACT RAIN, max. flow rate 6.8 l/min (at 3 bar)
- complete hand shower set with anti-scale system
- automatic bath/shower diverter
- 220mm projection
- height of mixer 347 mm
- height up to aerator 244 mm
- hole diameter spout 32 mm
- hole diameter valve 32 mm
- hole diameter for complete hand shower set 32 mm
- rosette for spout Ø 60mm
- rosette for complete hand shower set Ø 60mm
- rosette for deck valve Ø 60mm
- metal shower hose 1750mm with integrated anti-twist protection
- WRAS

Intrinsic protection against back flow.

| | | |
|--|--------------------------------|---------------|
|  | Brushed Bronze | 27 522 819-42 |
|  | Chrome | 27 522 819-00 |
|  | Brushed Platinum | 27 522 819-06 |
|  | Platinum | 27 522 819-08 |
|  | Dark Chrome | 27 522 819-19 |
|  | Brushed Durabronze (23kt Gold) | 27 522 819-28 |
|  | Brushed Dark Brass | 27 522 819-39 |
|  | Brushed Champagne (22kt Gold) | 27 522 819-46 |
|  | Champagne (22kt Gold) | 27 522 819-47 |
|  | Brushed Dark Platinum | 27 522 819-99 |

27 522 819 Product version from 3/13/2017

mm [inches]
M 1:10



Flow rate chart



Codes & Standards

ASME A112.18.1 cUPC DIN 4109 EN 1717

Executive Order ISO 3822 Ü-Zeichen
no. 1007



VAIA Five-hole bath mixer for deck mounting with diverter - Brushed Bronze

VAIA

27 522 819 Product version from 3/13/2017

Certificates and sustainability

IAPMO_4976

Belgaqua_22_278_2 WRAS_2310

LGA_29

27 522 819 Product version from 3/13/2017

Parts for other finishes can be found here: [Chrome](#)

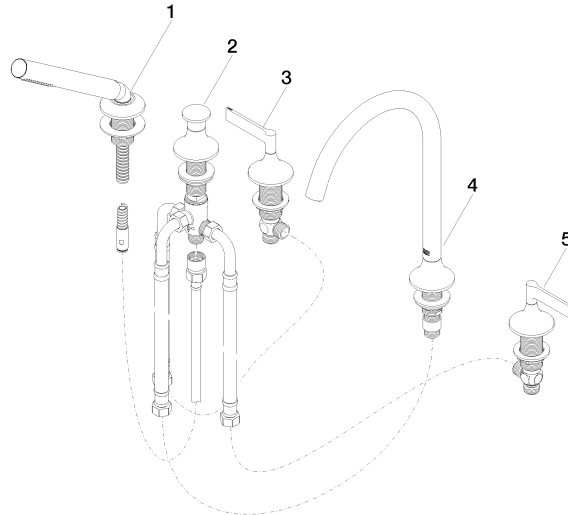

Spare parts list

| No. | Item Number | Name | Quantity used | Delivery time |
|--|---------------|---|---------------|---------------|
| 3 | 20 000 818-42 | handle (hot) | 1.00 | - |
| Spare part can no longer be ordered, please order the replacement item | | | | |
| 4 | 13 612 809-42 | spout | 1.00 | - |
| Spare part can no longer be ordered, please order the replacement item | | | | |
| 5 | 20 000 819-42 | handle (hot) | 1.00 | - |
| Spare part can no longer be ordered, please order the replacement item | | | | |
| 1 | 27 702 809-42 | VAIA Hand shower set for bath rim or tile edge installation - Brushed Bronze | 1.00 | 20 |
| 2 | 29 140 809-42 | VAIA Two-way diverter for bath rim or tile edge installation - Brushed Bronze | 1.00 | 20 |