



- spout: circular, air-enriched flow
 - max. flow 24.6 l/min at 3 bar flow pressure
 - Hand shower: COMPACT RAIN, max. flow rate 6.8 l/min (at 3 bar)
 - complete hand shower set with anti-scale system
 - automatic bath/shower diverter
 - 220mm projection
 - height of mixer 347 mm
 - height up to aerator 244 mm
 - hole diameter spout 32 mm
 - hole diameter single-lever mixer 35 mm
 - hole diameter for complete hand shower set 32 mm
 - rosette for spout Ø 60mm
 - rosette for single-lever mixer Ø 55mm
 - rosette for complete hand shower set Ø 60mm
 - metal shower hose 1750mm with integrated anti-twist protection
- Intrinsic protection against back flow.

	Chrome	27 632 809-00
	Brushed Platinum	27 632 809-06
	Platinum	27 632 809-08
	Dark Chrome	27 632 809-19
	Brushed Durabrass (23kt Gold)	27 632 809-28
	Brushed Dark Brass	27 632 809-39
	Brushed Bronze	27 632 809-42
	Brushed Champagne (22kt Gold)	27 632 809-46
	Champagne (22kt Gold)	27 632 809-47
	Brushed Dark Platinum	27 632 809-99

Recommended miscellaneous

	Perfecto installation kit -	12 614 970 90
--	-----------------------------	---------------

Recommended miscellaneous

	Decorative caps for Perfecto - Chrome	12 801 970-00
	• 1 pair	



VAIA Bath shower set for bath rim or tile edge installation - Chrome

VAIA

27 632 809 Product version from 4/1/2025

Certificates and sustainability

IAPMO_4976

LGA_29

Belgaqua_21-026-2

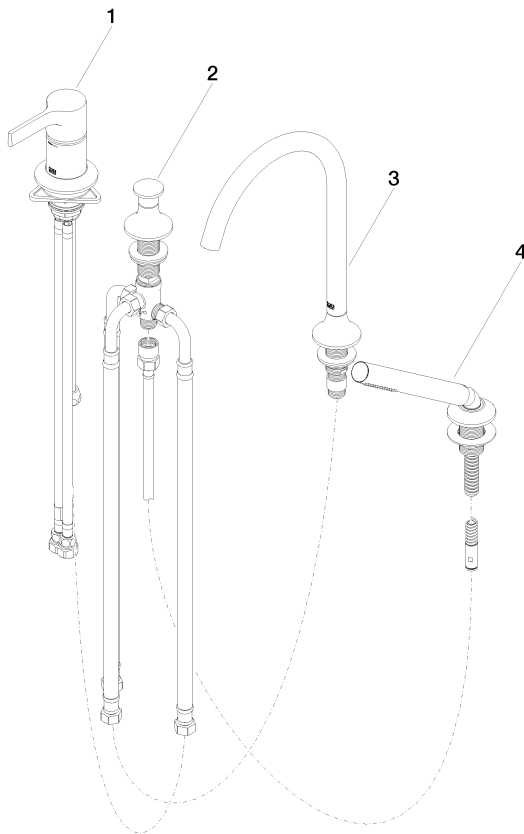

Spare parts list

No.	Item Number	Name	Quantity used	Delivery time
3	13 612 809-00	VAIA Bath spout without diverter for deck mounting - Chrome	1.00	-
Spare part can no longer be ordered, please order the replacement item				
1	29 300 809-00	connection	1.00	10
4	27 702 809-00	VAIA Hand shower set for bath rim or tile edge installation - Chrome	1.00	10
2	29 140 809-00	VAIA Two-way diverter for bath rim or tile edge installation - Chrome	1.00	10