

Hand shower set with individual rosettes with volume control - Chrome

SERIES SPECIFIC

27 809 980 Product version up to 6/3/2020



- COMPACT RAIN, max. flow rate 15 l/min (at 3 bar)
- with volume control
- with anti-scale system
- 3/8" shower outlet
- rosette for wall elbow 60 x 60mm
- rosette for shower holder 60 x 60mm
- metal shower hose 1250mm with integrated anti-twist protection
- 1/2" wall elbow
- WRAS

Intrinsic protection against back flow.

Recommended miscellaneous



Concealed wall elbow -

- max. recess depth 163 mm
- min. recess depth 90 mm

35 085 970 90

27 809 980 Product version up to 6/3/2020

mm [inches]

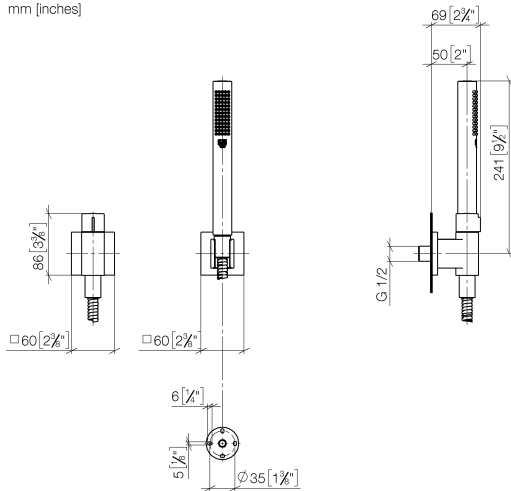

Flow rate chart



Codes & Standards

DIN 4109

EN 1717

ISO 3822

Scottish Water
Byelaws

UK Water Supply
Regulations

Ü-Zeichen



Hand shower set with individual rosettes with volume control - Chrome

SERIES SPECIFIC

27 809 980 Product version up to 6/3/2020

Certificates and sustainability

WRAS_2207

LGA_29

Belgaqua_22_280_2

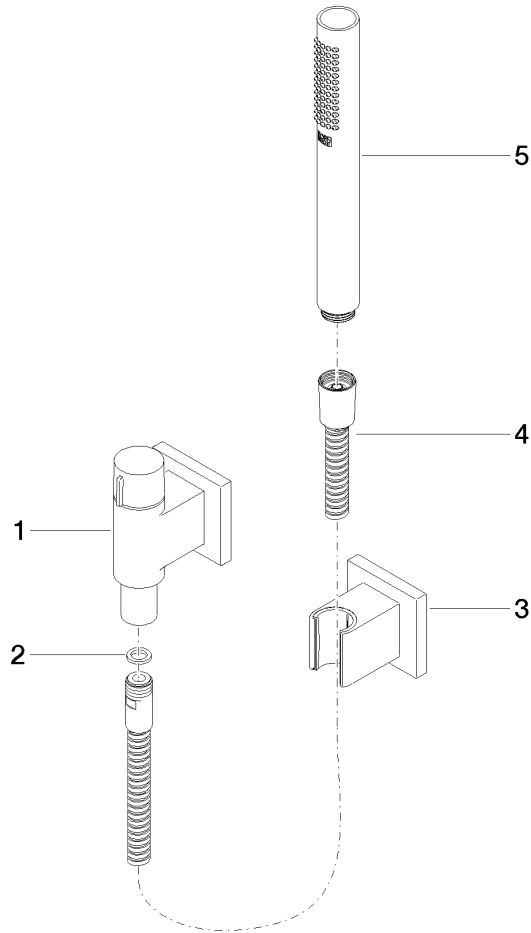

Spare parts list

| No. | Item Number | Name | Quantity used | Delivery time |
|-----|--------------------|--|---------------|---------------|
| 3 | 28 050 980-00 | Wall bracket - Chrome | 1.00 | 10 |
| 1 | 28 451 980-00 | connection | 1.00 | 60 |
| 4 | 90 30 02 072 00-00 | Metal shower hose 1/2" x 3/8" x 1250 mm - Chrome | 1.00 | 10 |
| 2 | 90 14 20 026 00 90 | seal | 1.00 | 2 |
| 5 | 90 12 11 140 40-00 | shower | 1.00 | 10 |