

MEM Concealed two-way diverter - Brushed Champagne (22kt Gold)

MEM

36 200 782    Product version from 4/1/2022



- rotary diverter
- rosette 60 x 60 mm
- WRAS

|   |                                |               |
|---|--------------------------------|---------------|
|  | Brushed Champagne (22kt Gold)  | 36 200 782-46 |
|  | Chrome                         | 36 200 782-00 |
|  | Brushed Platinum               | 36 200 782-06 |
|  | Platinum                       | 36 200 782-08 |
|  | Dark Chrome                    | 36 200 782-19 |
|  | Brushed Durabronze (23kt Gold) | 36 200 782-28 |
|  | Champagne (22kt Gold)          | 36 200 782-47 |
|  | Brushed Dark Platinum          | 36 200 782-99 |

Required miscellaneous

|   |  |               |
|---|--|---------------|
|  | <div>Concealed two-way diverter -</div> <div> <div>•max. recess depth 160 mm</div> <div>•min. recess depth 115 mm</div> </div> | 35 202 970 90 |
|---|--|---------------|

mm [inches]



Flow rate chart



Codes & Standards

|          |          |                        |                             |
|----------|----------|------------------------|-----------------------------|
| DIN 4109 | ISO 3822 | Scottish Water Byelaws | UK Water Supply Regulations |
|----------|----------|------------------------|-----------------------------|

Ü-Zeichen



## MEM Concealed two-way diverter - Brushed Champagne (22kt Gold)

---

MEM

36 200 782 Product version from 4/1/2022

Certificates and sustainability

---

LGA\_38

WRAS\_2307

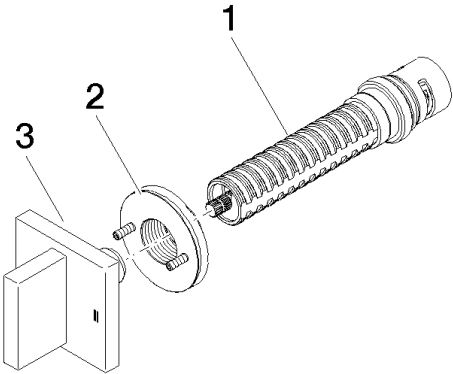

Spare parts list

| No. | Item Number        | Name     | Quantity used | Delivery time |
|-----|--------------------|----------|---------------|---------------|
| 1   | 90 90 03 304 10 90 | diverter | 1.00          | 2             |
| 3   | 90 20 78 002 08-46 | handle   | 1.00          | 30            |
| 2   | 90 21 02 181 00 90 | disc     | 1.00          | 2             |