







CL.1 Wall valve clockwise closing 1/2" - Brushed Champagne (22kt Gold)

CL.1

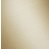
36 607 705

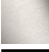

- rosette 60 x 60 mm
- without marking
- head part with cut-to-length spindle and sleeve
- WRAS 2011026, 2010066

	Brushed Champagne (22kt Gold)	36 607 705-46
	Chrome	36 607 705-00
	Brushed Platinum	36 607 705-06
	Dark Chrome	36 607 705-19
	Champagne (22kt Gold)	36 607 705-47
	Brushed Dark Platinum	36 607 705-99



CL.1 Wall valve clockwise closing 1/2" - Brushed Champagne (22kt Gold)

CL.1

36 607 705

mm [inches]

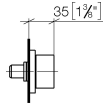
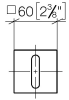

Codes & Standards

DIN 4109	EN 1111	ISO 3822	Scottish Water Byelaws
UK Water Supply Regulations	Ü-Zeichen		

Certificates

WRAS_2010	LGA_29	DVGW_DW- 6512DNO	WRAS_2011
-----------	--------	---------------------	-----------

36 607 705

Product version from 10/14/2020

Parts for other finishes can be found here: [Chrome](#)

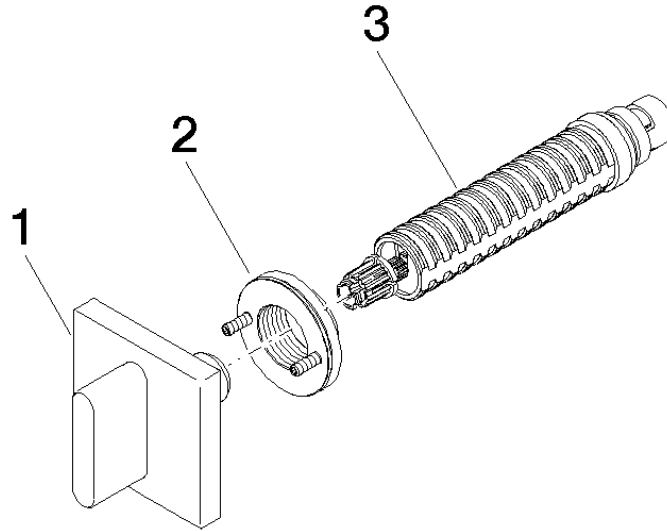



CL.1 Wall valve clockwise closing 1/2" - Brushed Champagne (22kt Gold)

CL.1

36 607 705

Spare parts list

Product version from 10/14/2020

No.	Item Number	Name	Quantity used	Delivery time
	90 20 70 051 01-46	handle	3	30