







CYO Wall valve clockwise closing 1/2" - Brushed Platinum

CYO

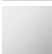
36 607 811



- without rosette
 - handle Ø 60mm
 - head part with cut-to-length spindle and sleeve
- NOTE: The handle inserts must be ordered separately from the fittings!

	Brushed Platinum	36 607 811-06
	Chrome	36 607 811-00
	Dark Chrome	36 607 811-19
	Brushed Durabrass (23kt Gold)	36 607 811-28
	Platinum / Brushed Platinum	36 607 811-36
	Durabrass / Brushed Durabrass (23kt Gold)	36 607 811-38
	Brushed Dark Platinum	36 607 811-99



CYO Wall valve clockwise closing 1/2" - Brushed Platinum

CYO

36 607 811

mm [inches]

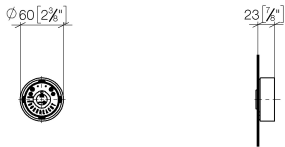

Codes & Standards

ASME A112.18.1	cUPC	DIN 4109	ISO 3822
----------------	------	----------	----------

Ü-Zeichen

Certificates and sustainability

LGA_38 IAPMO_4976 (

36 607 811

Parts for other
finishes can be found
here: [Chrome](#)

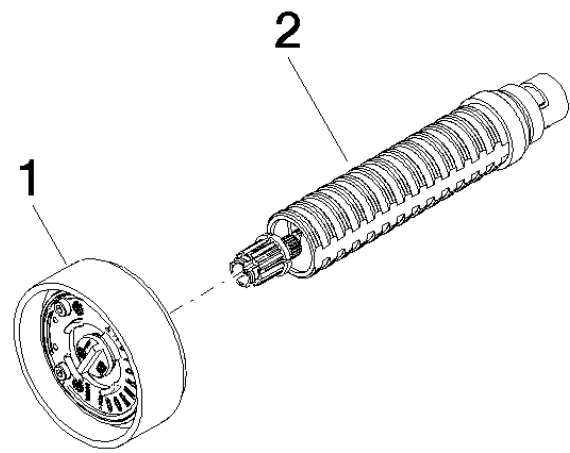

Spare parts list

No.	Item Number	Name	Quantity used	Delivery time
2	90 90 03 172 01 90	top	1.00	2
1	90 18 40 291 01-06	handle	1.00	10