

## MEM Wall-mounted basin mixer without pop-up waste - Chrome

MEM

36 712 782 Product version from 3/10/2014 to 10/27/2020



- 200mm projection
- fixed spout
- rectangular, air-enriched flow
- hole diameter valve 40 mm
- hole diameter spout 40 mm
- individual rosettes 60 x 60 mm
- max. flow 5.7 l/min
- lead-free
- This product can help a building meet the requirements of Green Building Rating Systems, e.g. LEED®, BREEAM®, DGNB
- WRAS

|  |                                |               |
|--|--------------------------------|---------------|
|  | Chrome                         | 36 712 782-00 |
|  | Brushed Platinum               | 36 712 782-06 |
|  | Platinum                       | 36 712 782-08 |
|  | Dark Chrome                    | 36 712 782-19 |
|  | Brushed Durabronze (23kt Gold) | 36 712 782-28 |
|  | Brushed Champagne (22kt Gold)  | 36 712 782-46 |
|  | Champagne (22kt Gold)          | 36 712 782-47 |
|  | Brushed Dark Platinum          | 36 712 782-99 |

### Required miscellaneous



- Concealed wall-mounted mixer centred spout -** 35 700 970 90
- max. recess depth 150 mm
  - min. recess depth 110 mm

### Required miscellaneous



- Concealed wall-mounted mixer variable positioning -** 35 720 970 90
- min. recess depth 110 mm
  - max. recess depth 150 mm

## MEM Wall-mounted basin mixer without pop-up waste - Chrome

MEM

36 712 782 Product version from 3/10/2014 to 10/27/2020

mm [inches]

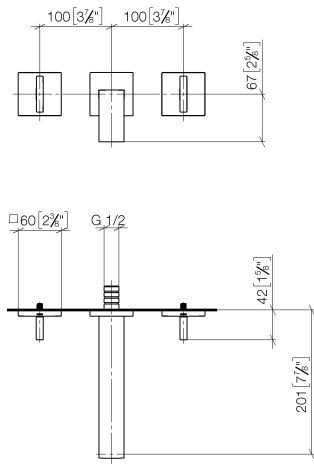

### Flow rate chart

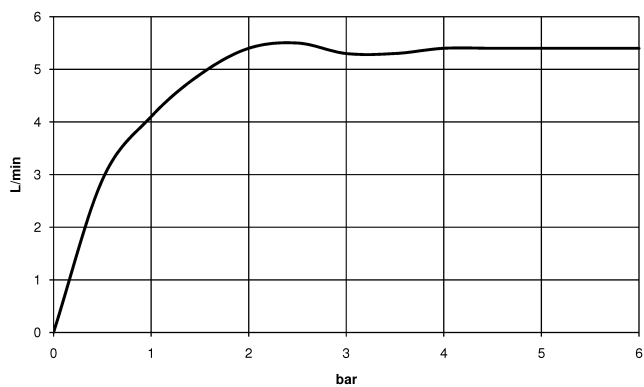

### Codes & Standards

DIN 4109

EN 200

ISO 3822

Scottish Water  
Byelaws

UK Water Supply  
Regulations

Ü-Zeichen

VA-Zeichen



MEM Wall-mounted basin mixer without pop-up waste - Chrome

MEM

36 712 782    Product version from 3/10/2014 to 10/27/2020

Certificates and sustainability

LGA\_18                      WRAS\_2204                      ETA\_19

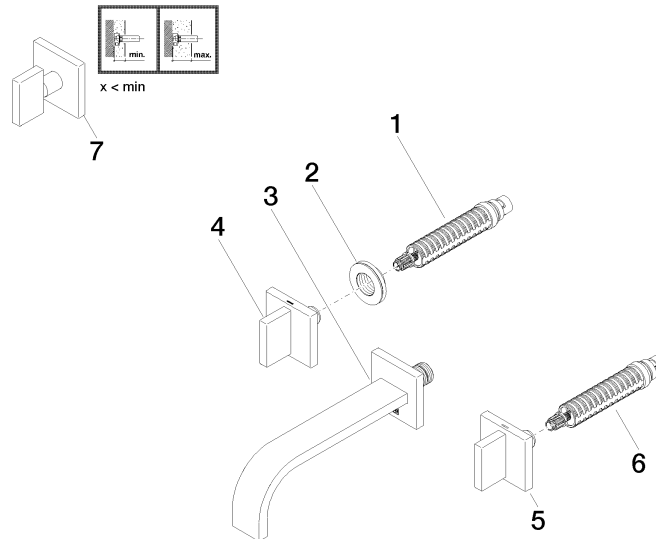

## Spare parts list

| No. | Item Number        | Name   | Quantity used | Delivery time |
|-----|--------------------|--|---------------|---------------|
| 1   | 90 90 03 156 00 90 | top  | 1.00          | 2             |
| 2   | 09 21 02 108 90    | disc   | 2.00          | 60            |
| 6   | 90 90 03 157 00 90 | top  | 1.00          | 2             |
| 3   | 13 800 782-00      | MEM Wall-mounted basin spout without pop-up waste - Chrome | 1.00          | 10            |
| 4   | 90 20 78 002 07-00 | handle ( hot )   | 1.00          | 10            |
| 5   | 90 20 78 002 06-00 | handle ( cold )  | 1.00          | 10            |
| 7   | 90 20 78 002 01-00 | handle   | 2.00          | 10            |