

38 550 004 Product version from 1/1/2025



- under-mounted
 - 550 x 400 mm
 - sink depth 175 mm
 - suitable for base units 600 mm
 - Radius 15 mm
- Drain and overflow set not included in the scope of supply. See Required miscellaneous.**
- Drain and overflow set not included in the scope of supply. See Required miscellaneous.

Required miscellaneous



Pop-up waste and overflow with electronic control 10 410 004-86

Required miscellaneous



Basin Waste mechanical 10 405 004-86

38 550 004 Product version from 1/1/2025

mm [inches]
1:10

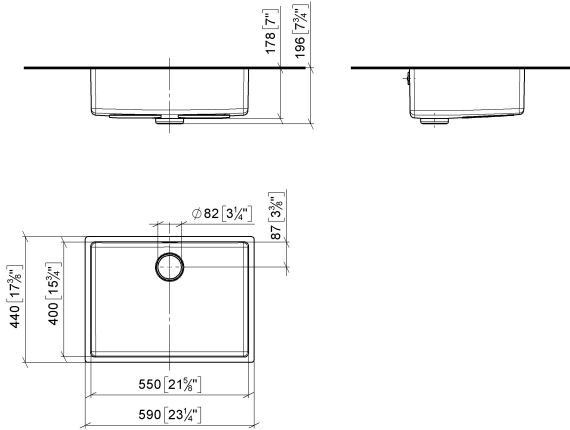

Certificates and sustainability

Leistungserklärung_ declaration_of_perfo
DOD rmance_DOD



Spare parts list

| No. | Item Number | Name | Quantity used | Delivery time |
|--|--------------------|---|---------------|---------------|
| 6 | 10 410 004-86 | Pop-up waste and overflow with electronic control | 1.00 | 2 |
| 1 | 90 11 01 135 00-86 | strainer | 1.00 | - |
| Spare part can no longer be ordered, please order the replacement item | | | | |
| 2 | 90 11 01 125 00 90 | seal | 1.00 | - |
| Spare part can no longer be ordered, please order the replacement item | | | | |
| 3 | 90 38 00 010 00 90 | fixing set | 1.00 | - |
| Spare part can no longer be ordered, please order the replacement item | | | | |
| 4 | 90 11 01 211 00 90 | pop-up waste | 1.00 | - |
| Spare part can no longer be ordered, please order the replacement item | | | | |
| 5 | 10 405 004-86 | Basin Waste mechanical | 1.00 | 2 |