

# Towel bar in two parts non-swivel - Light Gold

SERIES SPECIFIC

83 210 979    Product version from 7/1/2023



- gauge 72 mm
- width 112mm
- height 40 mm
- rosette Ø 40 mm
- 500mm projection

	Light Gold	83 210 979-26
	Chrome	83 210 979-00
	Brushed Platinum	83 210 979-06
	Dark Chrome	83 210 979-19
	Brushed Light Gold	83 210 979-27
	Matte Black	83 210 979-33
	Brushed Bronze	83 210 979-42
	Brushed Champagne (22kt Gold)	83 210 979-46
	Champagne (22kt Gold)	83 210 979-47
	Brushed Chrome	83 210 979-93
	Brushed Dark Platinum	83 210 979-99

## Towel bar in two parts non-swivel - Light Gold

SERIES SPECIFIC

83 210 979 Product version from 7/1/2023

mm [inches]

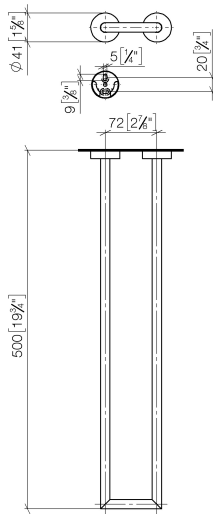

83 210 979    Product version from 7/1/2023

Parts for other  
 finishes can be found  
 here: [Chrome](#)

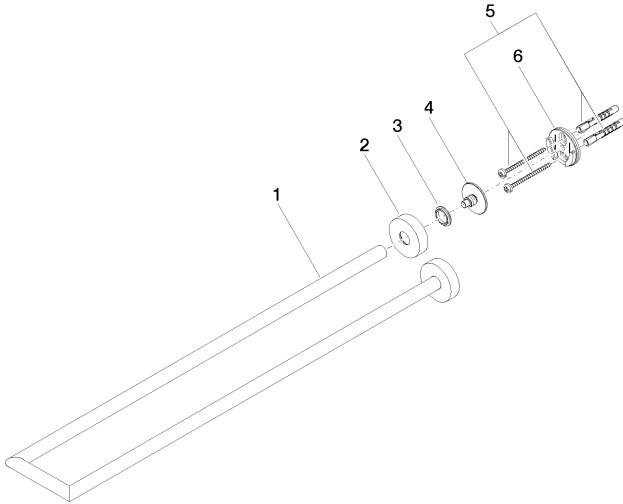

Spare parts list

No.	Item Number	Name	Quantity used	Delivery time
6	08 17 97 501 07	holder	2.00	2
4	08 17 97 560 90	holder	2.00	2
3	08 30 11 516 90	ring	2.00	2
5	05 30 31 025 00 90	fixing set	2.00	2
2	08 27 97 500-26	rosette	2.00	60
1	05 28 22 627 00-26	holder	1.00	60