





## CL.1 Inverseur à 2 voies à encastrer - Champagne brossé (Or 22cts)

CL.1

36 202 705

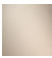
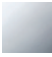
- inverseur rotatif
- rosace 60 x 60 mm



|   |                             |               |
|---|-----------------------------|---------------|
|  | Champagne brossé (Or 22cts) | 36 202 705-46 |
|  | Chrome                      | 36 202 705-00 |
|  | Platine brossé              | 36 202 705-06 |
|  | Dark Chrome                 | 36 202 705-19 |
|  | Champagne (Or 22cts)        | 36 202 705-47 |
|  | Dark Platinum brossé        | 36 202 705-99 |

36 202 705

mm [inches]

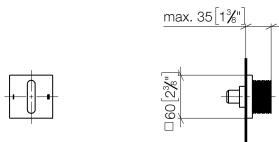

### Diagramme de débit

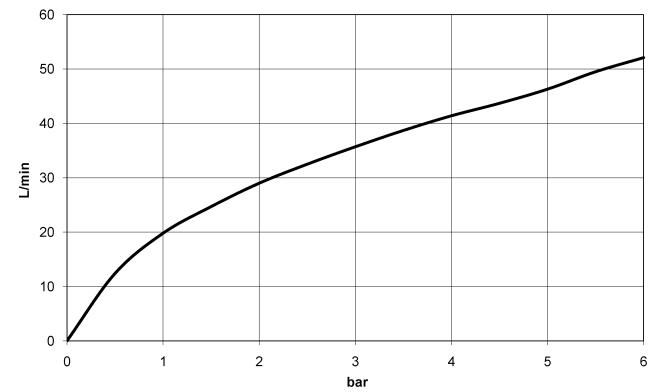

### Certificats

LGA\_38379.

WRAS\_2307045.

36 202 705

Les pièces pour les  
autres finitions  
peuvent être  
trouvées ici : Chrome

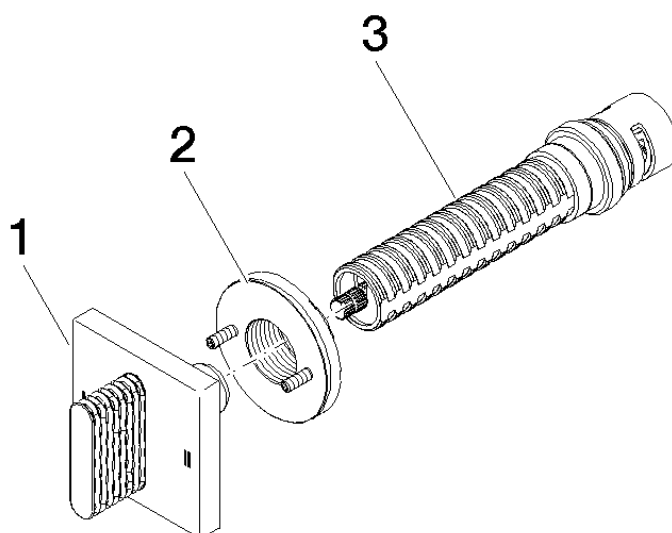

## Liste des pièces de rechange

| N° | Article Numéro     | Désignation | Fréquence de montage | Délai de livraison |
|----|--------------------|-------------|----------------------|--------------------|
| 1  | 90 20 70 053 08-46 | poignée     | 1                    | 30                 |
| 2  | 90 21 02 181 00 90 | rondelle    | 1                    | 2                  |
| 3  | 90 90 03 304 10 90 | inverseur   | 1                    | 2                  |