





36 627 706

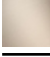

- avec structure CASCADE
- rosace 60 x 60 mm
- avec marquage froid
- tête de commande avec broche et douille à sectionner

| | | |
|---|-----------------------------|---------------|
|  | Platine brossé | 36 627 706-06 |
|  | Chrome | 36 627 706-00 |
|  | Dark Chrome | 36 627 706-19 |
|  | Champagne brossé (Or 22cts) | 36 627 706-46 |
|  | Champagne (Or 22cts) | 36 627 706-47 |
|  | Dark Platinum brossé | 36 627 706-99 |

Accessoires requis



- Robinet à encastrer 1/2" -** 35 607 970 90
- profondeur de montage max. 150 mm
 - profondeur de montage mini. 105 mm

36 627 706

mm [inches]

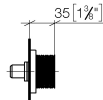
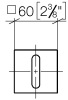

Certificats

DVGW_DW-
6501DN0116.

IAPMO_4976 (1).

LGA_29931.

WRAS_2010066.

LGA_29932.

36 627 706

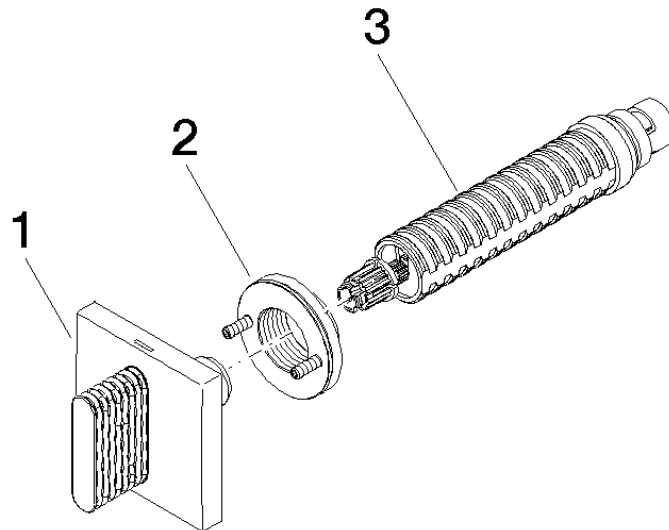

Liste des pièces de rechange

| N° | Article Numéro | Désignation | Fréquence de montage | Délai de livraison |
|----|--------------------|------------------|----------------------|--------------------|
| 1 | 90 20 70 053 02-06 | poignée (cold) | 1 | 10 |
| 2 | 90 21 02 108 00 90 | rondelle | 1 | 2 |
| 3 | 90 90 03 143 00 90 | tête céramique | 1 | 2 |