







**MEM Deck-mounted basin spout without pop-up waste - Brushed Champagne (22kt Gold)**

MEM

13 716 782 Product version from 7/1/2021

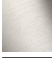

- 200mm projection
- fixed spout
- rectangular, air-enriched flow
- height of mixer 321 mm
- height up to aerator 190 mm
- hole diameter 35 mm
- rosette 60 x 60 mm
- 2x screw-in M 10 x 1 pressure hose, leak-tested
- 1/2" connection
- max. flow 5.7 l/min
- lead-free
- This product can help a building meet the requirements of Green Building Rating Systems, e.g. LEED®, BREEAM®, DGNB

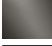
	Brushed Champagne (22kt Gold)	13 716 782-46
	Chrome	13 716 782-00
	Brushed Platinum	13 716 782-06
	Platinum	13 716 782-08
	Dark Chrome	13 716 782-19
	Brushed Durabronze (23kt Gold)	13 716 782-28
	Champagne (22kt Gold)	13 716 782-47
	Brushed Dark Platinum	13 716 782-99

# MEM Deck-mounted basin spout without pop-up waste - Brushed Champagne (22kt Gold)

MEM

13 716 782 Product version from 7/1/2021  
mm [inches]

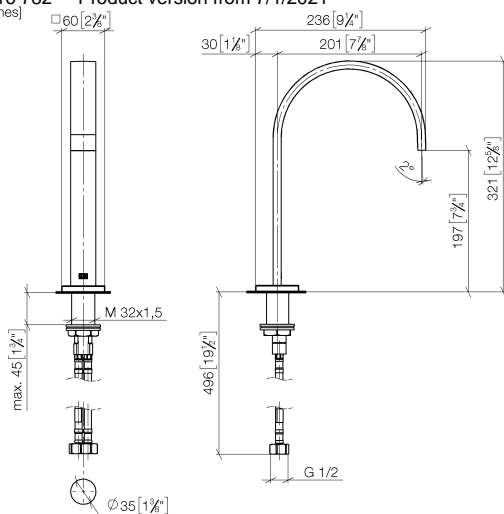

Flow rate chart



## Codes & Standards

DIN 4109

Executive Order  
no. 1007

ISO 3822

Ü-Zeichen



## MEM Deck-mounted basin spout without pop-up waste - Brushed Champagne (22kt Gold)

---

MEM

13 716 782 Product version from 7/1/2021

Certificates and sustainability

---

LGA\_28

GDV\_0400

# MEM Deck-mounted basin spout without pop-up waste - Brushed Champagne (22kt Gold)

MEM

13 716 782 Product version from 7/1/2021

Parts for other  
finishes can be found  
here: [Chrome](#)

