

TARA Deck valve clockwise closing cold or hot - Brushed Durabronz (23kt Gold)
TARA

20 000 892
Product version from 4/1/2025



- hole diameter 32 mm
- rosette Ø 55 mm
- WRAS

	Brushed Durabronz (23kt Gold)	20 000 892-28
	Chrome	20 000 892-00
	Brushed Platinum	20 000 892-06
	Platinum	20 000 892-08
	Dark Chrome	20 000 892-19
	Matte Black	20 000 892-33
	Brushed Dark Brass	20 000 892-39
	Brushed Bronze	20 000 892-42
	Brushed Champagne (22kt Gold)	20 000 892-46
	Champagne (22kt Gold)	20 000 892-47
	Brushed Chrome	20 000 892-93
	Brushed Dark Platinum	20 000 892-99

**TARA Deck valve clockwise closing cold or hot - Brushed Durabron (23kt Gold)**

TARA

20 000 892 Product version from 4/1/2025  
mm [inches]

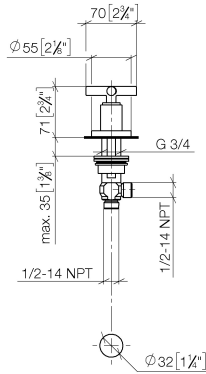

**Flow rate chart**



**Codes & Standards**

Scottish Water  
Byelaws

UK Water Supply  
Regulations



## TARA Deck valve clockwise closing cold or hot - Brushed Durabross (23kt Gold)

TARA

---

20 000 892 Product version from 4/1/2025

Certificates and sustainability

---

WRAS\_2112

