









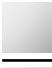
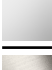

28 508 360



- spray head Ø 94mm
- Three settings: COMPACT RAIN, COMPACT SOFT FLOW, COMPACT AQUAPRESSURE FLOW, max. flow rate 7.6 l/min (at 3 bar)
- Function from: l/min
- with anti-scale system

Technical data:

- 200mm projection
- ball-joint pivotable through 30°
- rosette Ø 55 mm
- 1/2" connection

| | | |
|---|-------------------------------|--------------------|
|  | Brushed Durabrass (23kt Gold) | 28 508 360-28 0010 |
|  | Chrome | 28 508 360-00 0010 |
|  | Chrome | 28 508 360-00 |
|  | Brushed Platinum | 28 508 360-06 0010 |
|  | Brushed Platinum | 28 508 360-06 |
|  | Platinum | 28 508 360-08 0010 |
|  | Platinum | 28 508 360-08 |
|  | Durabrass (23kt Gold) | 28 508 360-09 0010 |
|  | Durabrass (23kt Gold) | 28 508 360-09 |
|  | Brushed Durabrass (23kt Gold) | 28 508 360-28 |
|  | Brushed Dark Platinum | 28 508 360-99 0010 |
|  | Brushed Dark Platinum | 28 508 360-99 |

28 508 360

mm [inches]

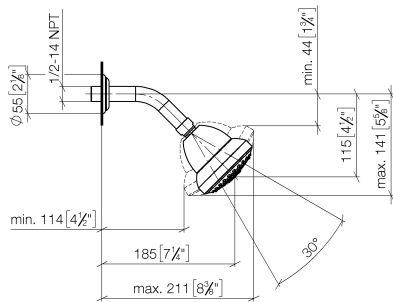

Codes & Standards

| | | |
|----------|----------|-----------|
| DIN 4109 | ISO 3822 | Ü-Zeichen |
|----------|----------|-----------|

Certificates and sustainability

LGA_38

28 508 360

Parts for other
finishes can be found
here: Chrome

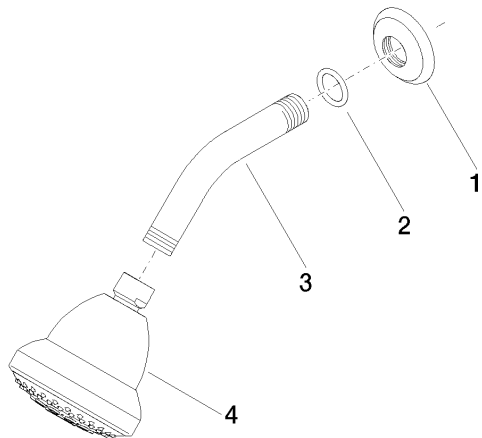

Spare parts list

| No. | Item Number | Name | Quantity used | Delivery time |
|-----|--------------------|------------|---------------|---------------|
| 1 | 09 27 35 003-28 | rosette | 1.00 | 60 |
| 3 | 09 11 03 011-28 | connection | 1.00 | 20 |
| 4 | 04 12 11 120 01-28 | shower | 1.00 | 20 |
| 2 | 90 14 10 026 00 90 | seal | 1.00 | 2 |