

## Body spray without volume control - Brushed Dark Platinum

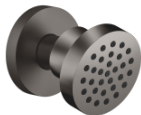









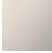

TARA

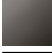
28 528 979

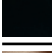

- spray head Ø 55mm
- ball-joint pivotable through 25° (in any direction)
- HORIZONTAL RAIN, max. flow rate 7 l/min (at 3 bar)
- with anti-scale system
- rosette Ø 55 mm
- 1/2" connection

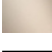
Fits: TARA, LISSÉ, VAIA, META

	Brushed Dark Platinum	28 528 979-99
	Chrome	28 528 979-00
	Brushed Platinum	28 528 979-06
	Platinum	28 528 979-08
	Durabrand (23kt Gold)	28 528 979-09
	Dark Chrome	28 528 979-19
	Light Gold	28 528 979-26
	Brushed Light Gold	28 528 979-27
	Brushed Durabrand (23kt Gold)	28 528 979-28
	Matte Black	28 528 979-33
	Brushed Bronze	28 528 979-42
	Brushed Champagne (22kt Gold)	28 528 979-46
	Champagne (22kt Gold)	28 528 979-47
	Brushed Chrome	28 528 979-93

### Recommended miscellaneous



#### Concealed wall elbow -

35 085 970 90

- max. recess depth 163 mm
- min. recess depth 90 mm

28 528 979

mm [inches]



Flow rate chart



Certificates

LGA\_38652.

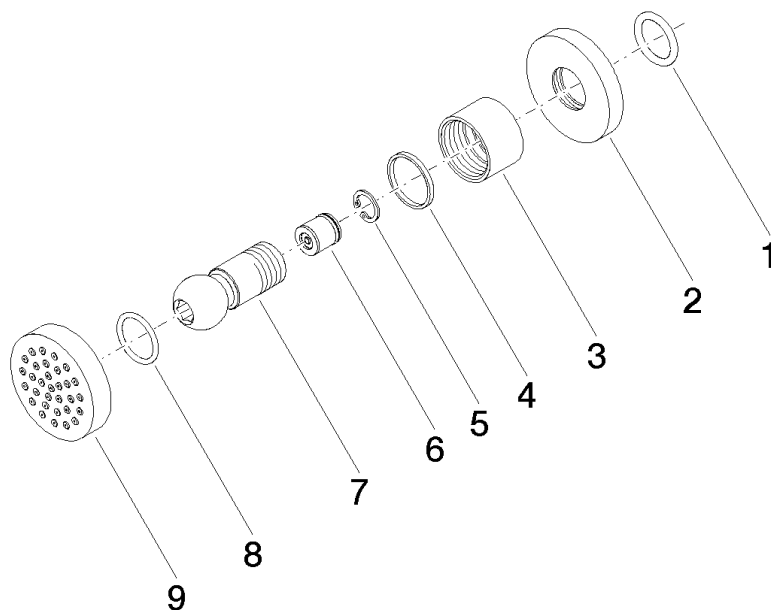

## Spare parts list

No.	Item Number	Name	Quantity used	Delivery time
1	90 14 10 026 00 90	seal	1	2
2	09 27 22 019-99	rosette	1	30
3	09 23 30 026-99	nut	1	30
4	09 14 15 010 90	ring	1	2
5	09 16 01 014 90	ring	1	2
6	90 23 01 147 00 90	back-flow preventer	1	2
7	09 21 40 016-99	connection	1	30
8	09 14 10 015 90	seal	1	2
9	90 12 05 027 00-99	casing ( completely )	1	30