

MADISON Rain shower with wall fixing FlowReduce 200 mm - Brushed Platinum

MADISON

28 544 977









- rain shower Ø 200 mm
- rain flow
- max. flow 7 l/min
- Function from: 6.5 l/min
- with anti-scale system

Technical dimensions:

- 435mm projection
- rosette Ø 55 mm
- 1/2" connection

Notes:

- This product can help a building meet the requirements of Green Building Rating Systems, e.g. LEED®, BREEAM®, DGNB

	Brushed Platinum	28 544 977-06
	Chrome	28 544 977-00
	Platinum	28 544 977-08
	Durabrass (23kt Gold)	28 544 977-09
	Brushed Durabrass (23kt Gold)	28 544 977-28
	Brushed Dark Platinum	28 544 977-99

MADISON Rain shower with wall fixing FlowReduce 200 mm - Brushed Platinum

MADISON

28 544 977
mm [inches]



Flow rate chart



Codes & Standards

DIN 4109

ISO 3822

Scottish Water
Byelaws

UK Water Supply
Regulations

Ü-Zeichen



MADISON Rain shower with wall fixing FlowReduce 200 mm - Brushed
Platinum

MADISON

28 544 977
Certificates and sustainability

LGA_38

WRAS_250102

28 544 977
Parts for other
finishes can be found
here: [Chrome](#)

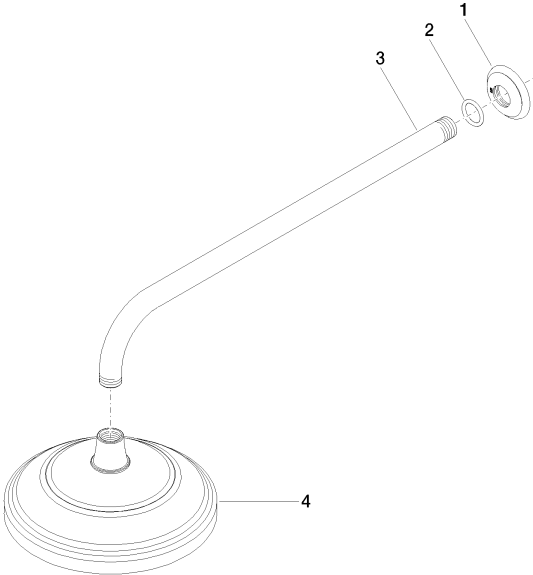

Spare parts list

No.	Item Number	Name	Quantity used	Delivery time
1	09 27 35 003-06	rosette	1.00	10
2	90 14 10 026 00 90	seal	1.00	2
4	90 12 05 038 20-06	shower	1.00	10
3	09 11 03 017-06	connection	1.00	10