







**MADISON Rain shower with wall fixing FlowReduce 200 mm - Brushed Dark Platinum**

28 544 977



- 435mm projection
- rain shower Ø 200 mm
- rain flow
- max. flow 7 l/min
- Function from: 6.5 l/min
- rosette Ø 55 mm
- 1/2" connection
- with anti-scale system
- This product can help a building meet the requirements of Green Building Rating Systems, e.g. LEED®, BREEAM®, DGNB

	Brushed Dark Platinum	28 544 977-99
	Chrome	28 544 977-00
	Brushed Platinum	28 544 977-06
	Platinum	28 544 977-08
	Durabrass (23kt Gold)	28 544 977-09
	Brushed Durabrass (23kt Gold)	28 544 977-28



MADISON Rain shower with wall fixing FlowReduce 200 mm - Brushed Dark Platinum

28 544 977  
mm [inches]

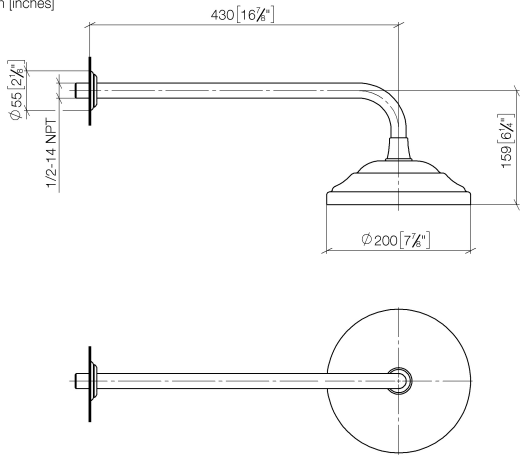

Flow rate chart



Codes & Standards

DIN 4109

ISO 3822

Ü-Zeichen



## MADISON Rain shower with wall fixing FlowReduce 200 mm - Brushed Dark Platinum

---

28 544 977

Certificates

---

LGA\_38

MADISON Rain shower with wall fixing FlowReduce 200 mm - Brushed Dark Platinum

28 544 977  
Parts for other  
finishes can be found  
here: [Chrome](#)

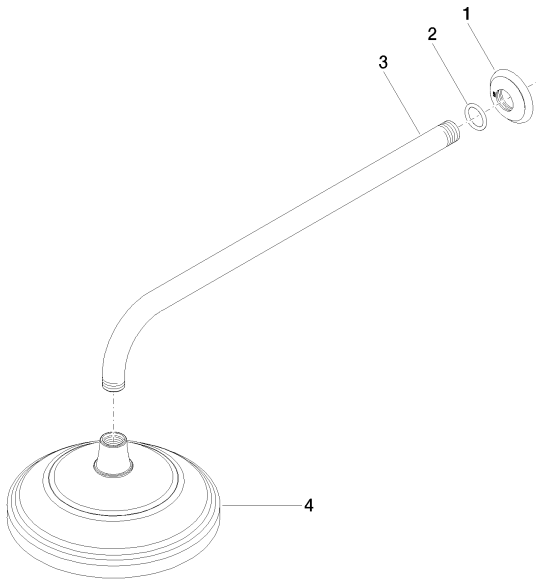

Spare parts list

No.	Item Number	Name	Quantity used	Delivery time
1	09 27 35 003-99	rosette	1	20
2	90 14 10 026 00 90	seal	1	2
3	09 11 03 017-99	connection	1	20
4	90 12 05 038 20-99	shower	1	20