

## Rain shower with wall fixing FlowReduce 220 mm - Chrome







IMO

28 648 670

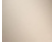
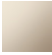

Fits: IMO, CYO

- 450mm projection
- rain shower Ø 220 mm
- rain flow
- max. flow 7 l/min
- Function from: 6 l/min
- rosette 65 x 65 mm
- 1/2" connection
- with anti-scale system
- quick clearing
- WRAS
- This product can help a building meet the requirements of Green Building Rating Systems, e.g. LEED®, BREEAM®, DGNB

|  |                               |               |
|--|-------------------------------|---------------|
|   | Chrome                        | 28 648 670-00 |
|   | Brushed Platinum              | 28 648 670-06 |
|   | Platinum                      | 28 648 670-08 |
|   | Dark Chrome                   | 28 648 670-19 |
|   | Brushed Durabrass (23kt Gold) | 28 648 670-28 |
|   | Matte Black                   | 28 648 670-33 |
|   | Brushed Champagne (22kt Gold) | 28 648 670-46 |
|   | Champagne (22kt Gold)         | 28 648 670-47 |
|   | Brushed Chrome                | 28 648 670-93 |
|  | Brushed Dark Platinum         | 28 648 670-99 |

Rain shower with wall fixing FlowReduce 220 mm - Chrome

IMO

28 648 670

mm [inches]

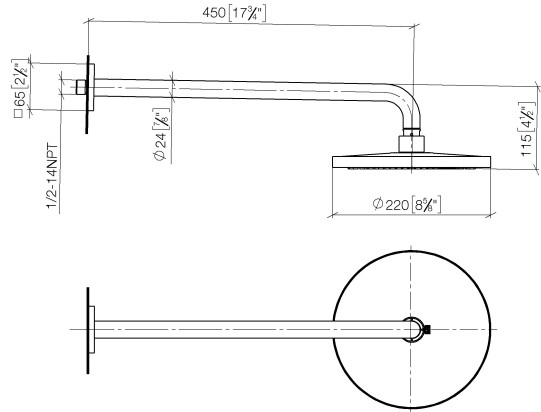

Flow rate chart

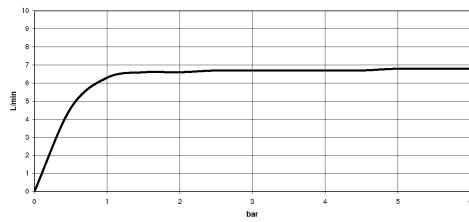

Certificates

LGA\_38655.

## Rain shower with wall fixing FlowReduce 220 mm - Chrome

IMO

28 648 670

Parts for other  
finishes can be found  
here: Brushed  
Platinum

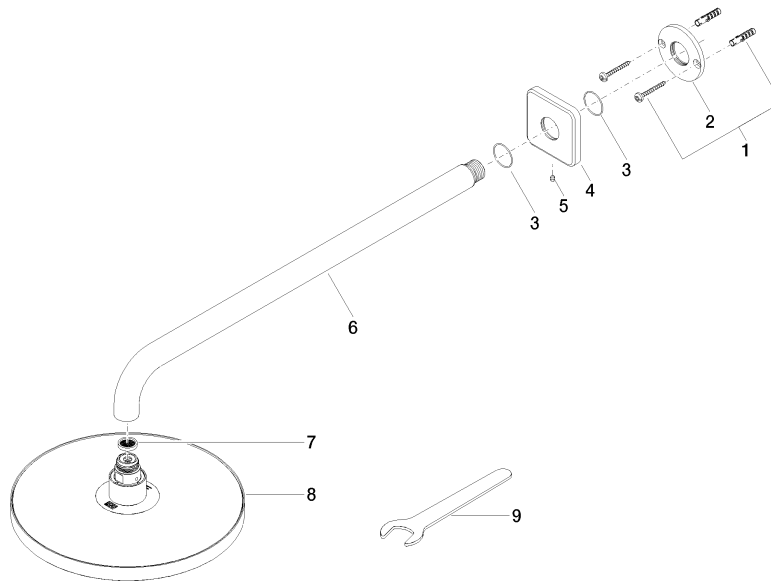

### Spare parts list

| No. | Item Number        | Name       | Quantity used | Delivery time |
|-----|--------------------|------------|---------------|---------------|
| 1   | 04 30 31 032 00 90 | fixing set | 1             | 2             |
| 2   | 09 17 20 120 90    | holder     | 1             | 2             |
| 3   | 09 14 10 150 90    | seal       | 1             | 2             |
| 4   | 09 27 67 015-00    | rosette    | 1             | 10            |
| 5   | 90 31 11 038 00 90 | pin        | 1             | 2             |
| 6   | 90 11 03 070 00-00 | pipe       | 1             | 10            |
| 7   | 09 23 01 075 90    | insert     | 1             | 2             |
| 8   | 90 12 05 092 20-00 | shower     | 1             | 10            |
| 9   | 90 30 09 069 00 90 | key        | 1             | 2             |