

## TARA ULTRA Single-lever mixer - Brushed Platinum

TARA ULTRA

33 800 875



- 201mm projection
- pivotable spout 360°
- air-enriched flow
- height of mixer 373 mm
- height up to aerator 240 mm
- hole diameter 35 mm
- max. flow 8 l/min at 3 bar flow pressure
- lead-free
- This product can help a building meet the requirements of Green Building Rating Systems, e.g. LEED®, BREEAM®, DGNB

|   |                               |               |
|---|-------------------------------|---------------|
|    | Brushed Platinum              | 33 800 875-06 |
|    | Chrome                        | 33 800 875-00 |
|    | Platinum                      | 33 800 875-08 |
|    | Durabrass (23kt Gold)         | 33 800 875-09 |
|    | Dark Chrome                   | 33 800 875-19 |
|    | Brushed Durabrass (23kt Gold) | 33 800 875-28 |
|    | Matte Black                   | 33 800 875-33 |
|    | Brushed Champagne (22kt Gold) | 33 800 875-46 |
|    | Champagne (22kt Gold)         | 33 800 875-47 |
|   | Brushed Chrome                | 33 800 875-93 |
|  | Brushed Dark Platinum         | 33 800 875-99 |

### Recommended miscellaneous

**Strainer waste with control handle - Brushed Platinum** 10 712 970-06



### Recommended miscellaneous

**Dispenser without rosette - Brushed Platinum** 82 424 970-06



The graph shows the relationship between bar length and luminosity. The x-axis, labeled 'bar', ranges from 0 to 6. The y-axis, labeled 'Lumin', ranges from 0 to 10. The curve starts at the origin (0,0) and increases rapidly, reaching a luminosity of about 7.5 at a bar length of 1. After this point, the curve flattens out, with luminosity increasing only slightly to about 8.1 at a bar length of 6.

| bar | Lumin |
|-----|-------|
| 0   | 0.0   |
| 0.5 | 4.5   |
| 1.0 | 7.5   |
| 1.5 | 7.8   |
| 2.0 | 7.9   |
| 3.0 | 8.0   |
| 4.0 | 8.0   |
| 5.0 | 8.1   |
| 6.0 | 8.1   |

GDV\_0400195.      LGA\_18899.      WRAS\_2101012.      ETA\_18980.

33 800 875

Parts for other  
finishes can be found  
here: [Chrome](#)

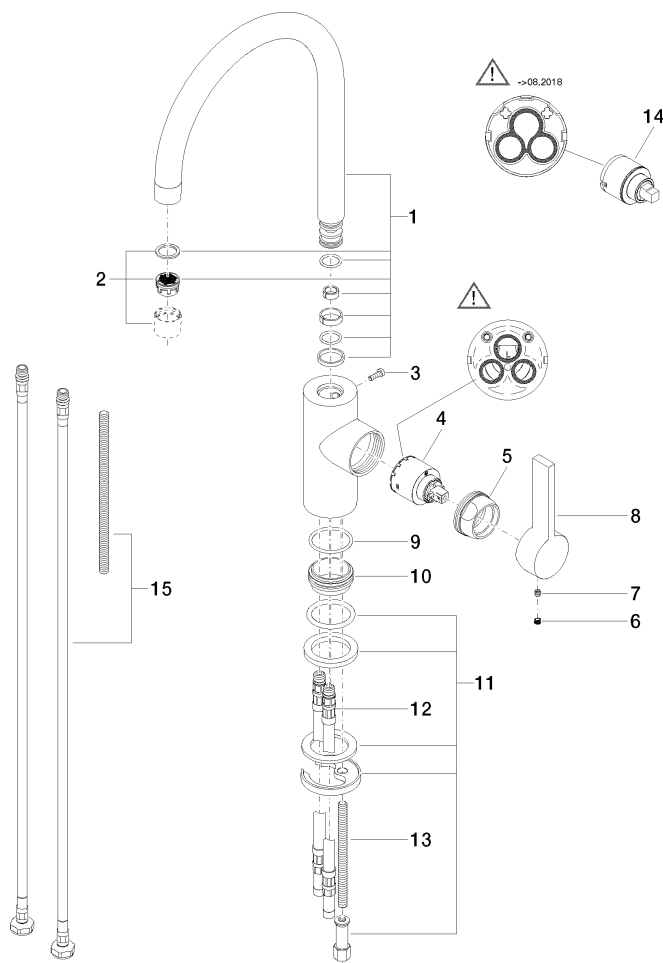

## Spare parts list

| No. | Item Number        | Name       | Quantity used | Delivery time |
|-----|--------------------|------------|---------------|---------------|
| 1   | 90 28 22 204 02-06 | spout      | 1             | 10            |
| 2   | 90 23 01 004 07-06 | aerator    | 1             | 10            |
| 3   | 09 30 30 080 90    | screw      | 1             | 2             |
| 4   | 90 15 05 061 00 90 | cartridge  | 1             | 60            |
| 5   | 09 24 04 107-06    | nut        | 1             | 10            |
| 6   | 90 31 20 109 00 90 | plug       | 1             | 2             |
| 7   | 90 31 11 030 00 90 | pin        | 1             | 2             |
| 8   | 09 20 79 040-06    | handle     | 1             | 10            |
| 9   | 09 14 10 119 90    | seal       | 1             | 2             |
| 10  | 09 28 10 109-07    | ring       | 1             | 30            |
| 11  | 04 30 11 085 88 90 | fixing set | 1             | 2             |
| 12  | 04 30 04 016 00 90 | hose       | 2             | 60            |
| 13  | 09 31 11 012 90    | pin        | 1             | 2             |
| 14  | 90 15 05 045 00 90 | cartridge  | 1             | 2             |
| 15  | 12 803 970 90      | extension  | 1             | 60            |