

VAIA Single-lever mixer for rinsing/Profi spray - Chrome

VAIA

33 810 809    Product version from 7/1/2023



- 202mm projection
  - pivotable spout 360°
  - air-enriched flow
  - max. flow 7 l/min at 3 bar flow pressure
  - lead-free
  - This product can help a building meet the requirements of Green Building Rating Systems, e.g. LEED®, BREEAM®, DGNB
  - WRAS
- Single-lever mixer for combining with rinsing/Profi spray only

|   |                               |               |
|---|-------------------------------|---------------|
|    | Chrome                        | 33 810 809-00 |
|    | Brushed Platinum              | 33 810 809-06 |
|    | Platinum                      | 33 810 809-08 |
|    | Durabrass (23kt Gold)         | 33 810 809-09 |
|    | Dark Chrome                   | 33 810 809-19 |
|    | Brushed Durabrass (23kt Gold) | 33 810 809-28 |
|    | Matte Black                   | 33 810 809-33 |
|    | Brushed Bronze                | 33 810 809-42 |
|    | Brushed Champagne (22kt Gold) | 33 810 809-46 |
|   | Champagne (22kt Gold)         | 33 810 809-47 |
|  | Brushed Chrome                | 33 810 809-93 |
|  | Brushed Dark Platinum         | 33 810 809-99 |

Recommended miscellaneous



VAIA Dispenser with rosette - Chrome

82 434 809-00

Recommended miscellaneous



VAIA Rinsing spray set - Chrome

27 718 809-00

33 810 809 Product version from 7/1/2023

mm [inches]

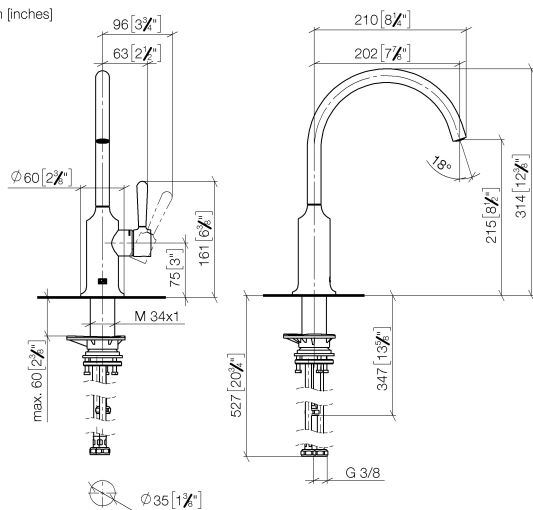

## Flow rate chart

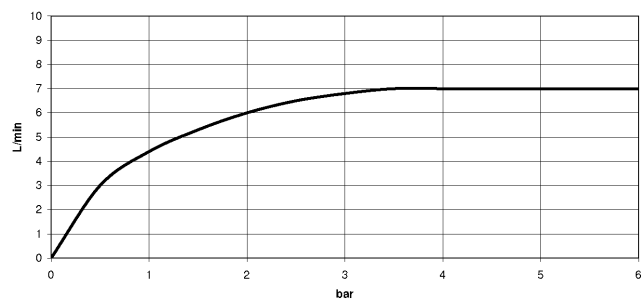

## Codes & Standards

DIN 4109

ISO 3822

Scottish Water  
Byelaws

UK Water Supply  
Regulations

## Ü-Zeichen



## VAIA Single-lever mixer for rinsing/Profi spray - Chrome

VAIA

33 810 809 Product version from 7/1/2023

### Certificates and sustainability

LGA\_38

WRAS\_240602

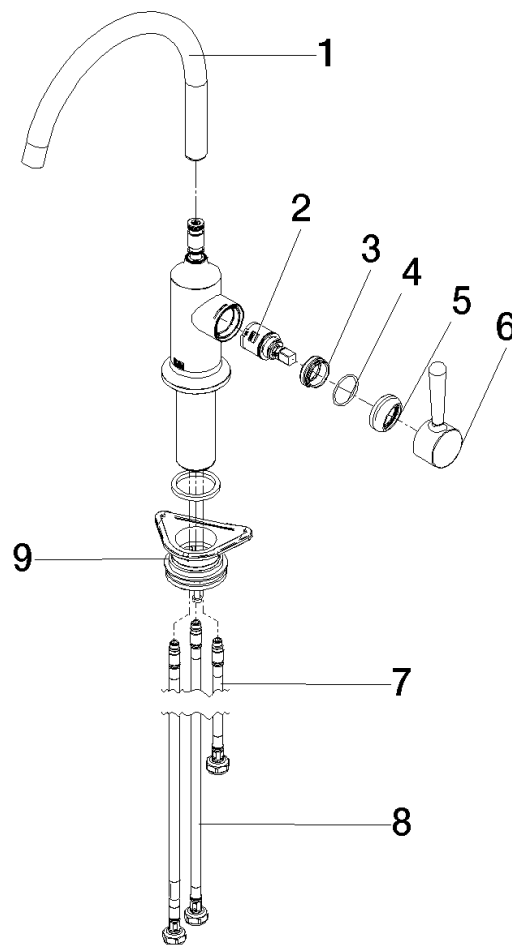

## Spare parts list

| No. | Item Number        | Name       | Quantity used | Delivery time |
|-----|--------------------|------------|---------------|---------------|
| 6   | 90 20 80 050 00-00 | handle     | 1.00          | 10            |
| 4   | 09 14 10 091 90    | seal       | 1.00          | 2             |
| 3   | 09 24 04 266 90    | nut        | 1.00          | 2             |
| 7   | 04 30 04 100 00 90 | hose       | 1.00          | 2             |
| 8   | 04 30 04 101 00 90 | hose       | 2.00          | 2             |
| 5   | 90 28 30 052 00-00 | cover      | 1.00          | 10            |
| 9   | 04 23 10 044 08 90 | fixing set | 1.00          | 2             |
| 2   | 90 15 05 042 00 90 | cartridge  | 1.00          | 2             |
| 1   | 90 28 22 313 02-00 | spout      | 1.00          | 10            |