

META Bath thermostat for wall mounting with hand shower set - Brushed Bronze

META

34 234 979 Product version from 7/1/2023



- spout: circular, air-enriched flow
- max. flow 16.9 l/min at 3 bar flow pressure
- Hand shower: COMPACT RAIN, max. flow rate 6.8 l/min (at 3 bar)
- complete hand shower set with anti-scale system
- rotary diverter with volume control and shut-off function
- slide-on rosettes Ø 60 mm
- 210mm projection
- 1/2" connection
- gauge 150 mm - 15 mm
- metal shower hose 1250mm with integrated anti-twist protection
- shower holder rosette Ø 57mm

Intrinsic protection against back flow.

	Brushed Bronze	34 234 979-42
	Chrome	34 234 979-00
	Brushed Platinum	34 234 979-06
	Dark Chrome	34 234 979-19
	Light Gold	34 234 979-26
	Brushed Light Gold	34 234 979-27
	Matte Black	34 234 979-33
	Brushed Dark Brass	34 234 979-39
	Brushed Champagne (22kt Gold)	34 234 979-46
	Champagne (22kt Gold)	34 234 979-47
	Brushed Chrome	34 234 979-93
	Brushed Dark Platinum	34 234 979-99

META Bath thermostat for wall mounting with hand shower set - Brushed Bronze

META

34 234 979 Product version from 7/1/2023
mm [inches]

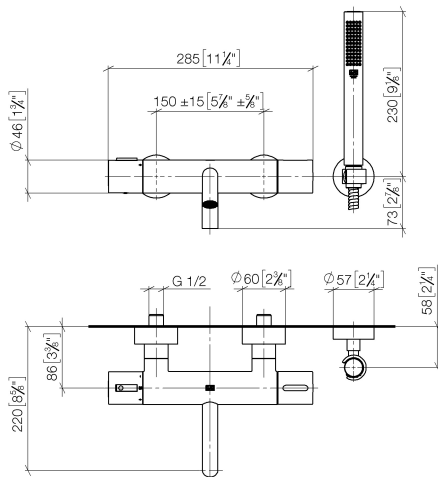

Flow rate chart

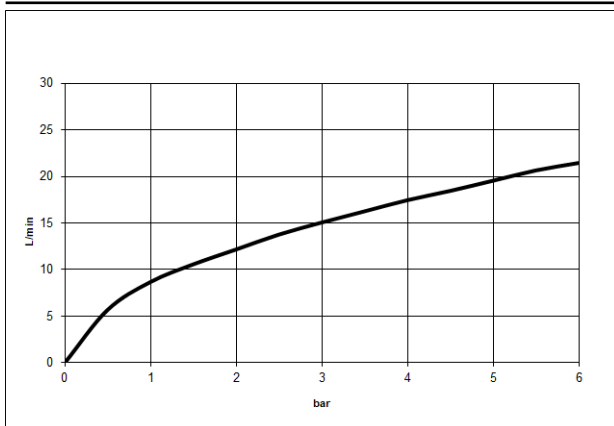

Codes & Standards

DIN 4109

ISO 3822

Ü-Zeichen



META Bath thermostat for wall mounting with hand shower set - Brushed Bronze

META

34 234 979 Product version from 7/1/2023

Certificates and sustainability

LGA_18

META Bath thermostat for wall mounting with hand shower set - Brushed Bronze

META

34 234 979 Product version from 7/1/2023

Parts for other
finishes can be found
here: [Chrome](#)

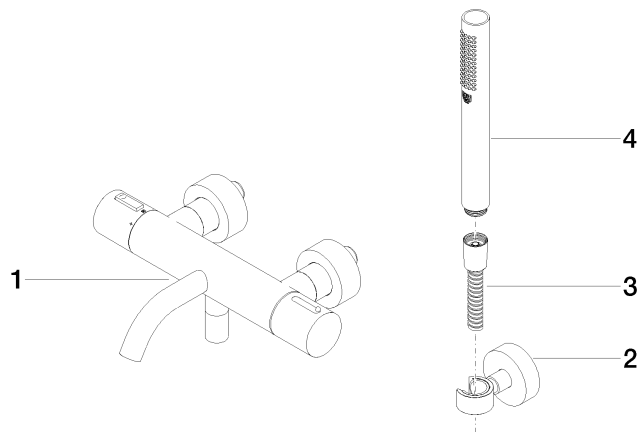

Spare parts list

No.	Item Number	Name	Quantity used	Delivery time
1	34 201 979-42	META Bath thermostat for wall mounting without shower set - Brushed Bronze	1.00	20
3	90 30 02 072 00-42	hose	1.00	20
2	28 050 920-42	holder	1.00	-
Spare part can no longer be ordered, please order the replacement item				
4	28 019 979-42	Hand shower - Brushed Bronze	1.00	-
Spare part can no longer be ordered, please order the replacement item				