

Shower thermostat for wall installation - Brushed Platinum

SERIES-VARIOUS

34 445 979 Product version from 6/1/2025



- without regulator handle
- with FlowReduce function
- slide-on rosettes Ø 70 mm
- 3/8" shower outlet
- 1/2" connection
- gauge 150 mm - 13 mm

Notes:

- inherently safe from back flow

| | | |
|---|-------------------------------------|---------------|
|  | Brushed Platinum | 34 445 979-06 |
|  | Chrome | 34 445 979-00 |
|  | Platinum | 34 445 979-08 |
|  | Dark Chrome | 34 445 979-19 |
|  | Brushed Light Gold | 34 445 979-27 |
|  | Brushed Durabrass (23kt Gold) | 34 445 979-28 |
|  | Matte Black | 34 445 979-33 |
|  | Brushed Dark Brass | 34 445 979-39 |
|  | Brushed Bronze | 34 445 979-42 |
|  | Brushed Champagne (22kt Gold) | 34 445 979-46 |
|  | Champagne (22kt Gold) | 34 445 979-47 |
|  | Brushed Chrome | 34 445 979-93 |
|  | Brushed Dark Platinum | 34 445 979-99 |

34 445 979 Product version from 6/1/2025

mm [inches]

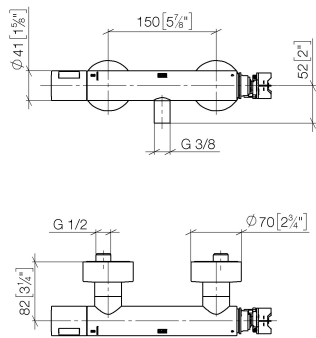

Flow rate chart



Parts for other
finishes can be found
here: [Chrome](#)



Spare parts list

| No. | Item Number | Name | Quantity used | Delivery time |
|--|--------------------|--------------|---------------|---------------|
| 1 | 90 17 33 030 01-06 | handle | 1.00 | - |
| Spare part can no longer be ordered, please order the replacement item | | | | |
| 5 | 04 11 04 030 00 90 | connection | 1.00 | 2 |
| 2 | 90 12 12 072 00 90 | base | 1.00 | - |
| Spare part can no longer be ordered, please order the replacement item | | | | |
| 7 | 90 31 20 540 00 90 | flow reducer | 1.00 | - |
| Spare part can no longer be ordered, please order the replacement item | | | | |
| 6 | 90 31 20 057 00-06 | rosette | 1.00 | - |
| Spare part can no longer be ordered, please order the replacement item | | | | |
| 8 | 90 21 02 069 01-06 | cover | 1.00 | - |
| Spare part can no longer be ordered, please order the replacement item | | | | |
| 4 | 90 31 20 530 00 90 | flow reducer | 1.00 | - |
| Spare part can no longer be ordered, please order the replacement item | | | | |
| 3 | 90 15 02 071 00 90 | top | 1.00 | - |
| Spare part can no longer be ordered, please order the replacement item | | | | |