





CL.1 Wall valve clockwise closing cold 1/2" - Brushed Dark Platinum

CL.1

36 607 706

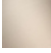
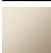

- rosette 60 x 60 mm
- with cold marking
- head part with cut-to-length spindle and sleeve

	Brushed Dark Platinum	36 607 706-99
	Chrome	36 607 706-00
	Brushed Platinum	36 607 706-06
	Dark Chrome	36 607 706-19
	Brushed Champagne (22kt Gold)	36 607 706-46
	Champagne (22kt Gold)	36 607 706-47

Required miscellaneous

	<b>Wall valve 1/2" -</b> •max. recess depth 150 mm •min. recess depth 105 mm	35 607 970 90
-------------------------------------------------------------------------------------------------	------------------------------------------------------------------------------------	---------------

36 607 706

mm [inches]



Certificates

DVGW_DW- 6501DN0116.	IAPMO_4976 (1).	LGA_29931.	WRAS_2010066.	LGA_29932.
-------------------------	-----------------	------------	---------------	------------

36 607 706

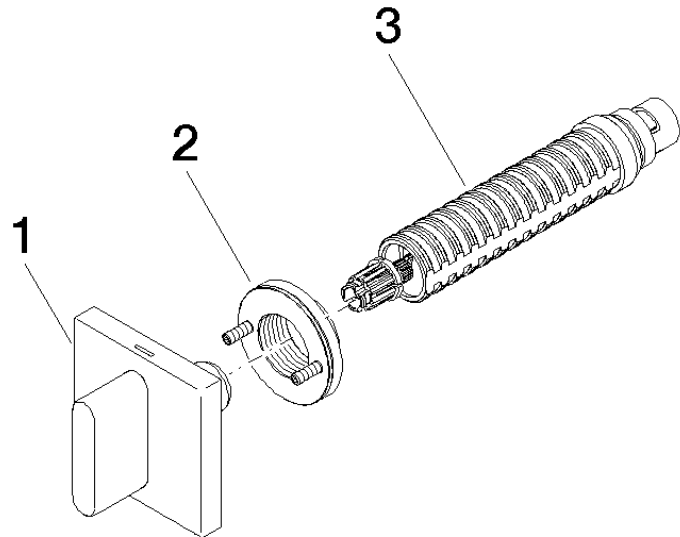

Spare parts list

No.	Item Number	Name	Quantity used	Delivery time
1	90 20 70 051 02-99	handle ( cold )	1	30
2	90 21 02 108 00 90	disc	1	2
3	90 90 03 143 00 90	top	1	2