







CL.1 Wall valve clockwise closing cold 1/2" - Dark Chrome

CL.1

36 627 706 Product version from 10/14/2020



- with CASCADE structure
- rosette 60 x 60 mm
- with cold marking
- head part with cut-to-length spindle and sleeve
- WRAS

	Dark Chrome	36 627 706-19
	Chrome	36 627 706-00
	Brushed Platinum	36 627 706-06
	Brushed Champagne (22kt Gold)	36 627 706-46
	Champagne (22kt Gold)	36 627 706-47
	Brushed Dark Platinum	36 627 706-99

Required miscellaneous

	<div> <div>Wall valve 1/2" -</div> <div> <div>•max. recess depth 150 mm</div> <div>•min. recess depth 105 mm</div> </div> </div>	35 607 970 90
-------------------------------------------------------------------------------------------------	----------------------------------------------------------------------------------------------------------------------------------	---------------

CL.1 Wall valve clockwise closing cold 1/2" - Dark Chrome

CL.1

36 627 706 Product version from 10/14/2020

mm [inches]



Codes & Standards

ASME A112.18.1	cUPC	DIN 4109	ISO 3822
Scottish Water Byelaws	UK Water Supply Regulations	Ü-Zeichen	

Certificates and sustainability

LGA_29	WRAS_2010	IAPMO_4976 (
--------	-----------	--------------

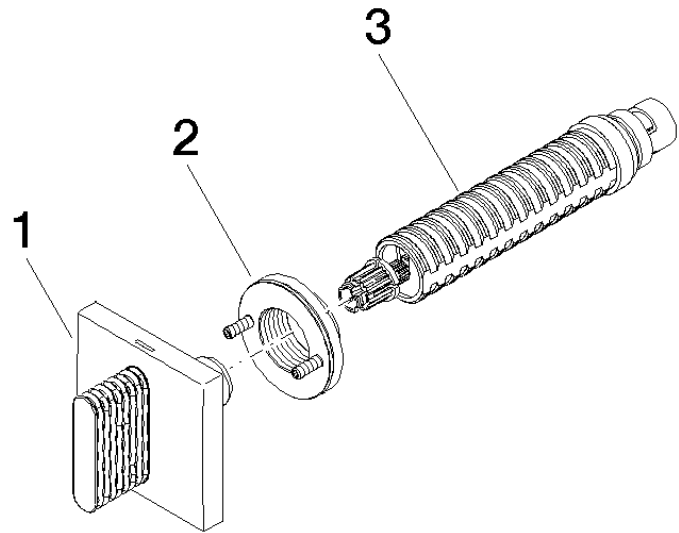

Spare parts list

No.	Item Number	Name	Quantity used	Delivery time
1	90 20 70 053 02-19	handle (cold)	1.00	20
2	90 21 02 108 00 90	disc	1.00	2
3	90 90 03 143 00 90	top	1.00	2