

IMO Washstand fitting with electronic opening and closing function without pop-up waste - Brushed Platinum

IMO

44 515 670    Product version from 6/1/2024



- Infrared sensor technology
- 130mm projection
- height of mixer 135 mm
- height up to aerator 74 mm
- hole diameter 35 mm
- fixed spout
- max. flow 5.7 l/min
- rectangular, air-enriched flow
- suitable for thermal disinfection
- Automatic shut-off after pre-set time is reached
- Direct temperature control at faucet
- Battery-powered (batteries not included)
- 1x CR-P2 battery required
- 2x screw-in M 8 x 1 pressure hose, leak-tested
- lead-free
- This product can help a building meet the requirements of Green Building Rating Systems, e.g. LEED®, BREEAM®, DGNB
- WRAS

Batteries not included

|   |                               |               |
|---|-------------------------------|---------------|
|  | Brushed Platinum              | 44 515 670-06 |
|  | Chrome                        | 44 515 670-00 |
|  | Platinum                      | 44 515 670-08 |
|  | Brushed Light Gold            | 44 515 670-27 |
|  | Brushed Durabrass (23kt Gold) | 44 515 670-28 |
|  | Matte Black                   | 44 515 670-33 |
|  | Brushed Chrome                | 44 515 670-93 |
|  | Brushed Dark Platinum         | 44 515 670-99 |

# IMO Washstand fitting with electronic opening and closing function without pop-up waste - Brushed Platinum

IMO

44 515 670 Product version from 6/1/2024  
mm [inches]

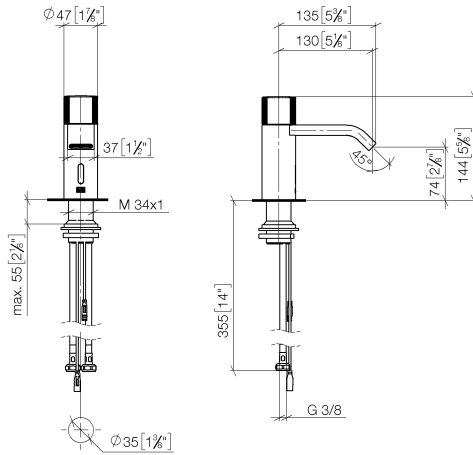

## Flow rate chart

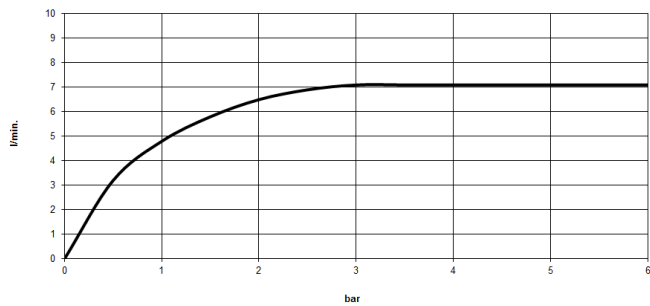

## Codes & Standards

DIN 4109

ISO 3822

Scottish Water  
Byelaws

UK Water Supply  
Regulations

Ü-Zeichen



## IMO Washstand fitting with electronic opening and closing function without pop-up waste - Brushed Platinum

---

IMO

44 515 670 Product version from 6/1/2024

Certificates and sustainability

---

LGA\_38

WRAS\_2212

# IMO Washstand fitting with electronic opening and closing function without pop-up waste - Brushed Platinum

IMO

44 515 670 Product version from 6/1/2024

Parts for other  
finishes can be found  
here: [Chrome](#)

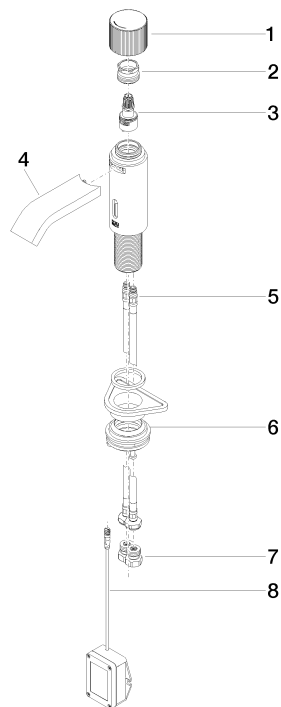

## Spare parts list

| No. | Item Number        | Name                  | Quantity used | Delivery time |
|-----|--------------------|-----------------------|---------------|---------------|
| 2   | 09 24 04 565 90    | nut                   | 1.00          | 60            |
| 1   | 90 20 66 122 00-06 | handle                | 1.00          | 10            |
| 5   | 04 30 04 100 00 90 | hose                  | 2.00          | 2             |
| 8   | 90 10 01 250 00 90 | casingwithout battery | 1.00          | 2             |
| 4   | 90 28 22 239 00-06 | spout                 | 1.00          | 10            |
| 7   | 90 24 03 314 00 90 | nipple set            | 2.00          | 2             |
| 6   | 04 23 10 044 08 90 | fixing set            | 1.00          | 2             |
| 3   | 90 90 03 173 00 90 | top                   | 1.00          | 2             |