

CL.1 Three-hole basin mixer without pop-up waste - Brushed Dark Platinum

CL.1

ST 010 101 4705



- 160mm projection
- fixed spout
- rectangular spray pattern with 40 individual jets
- height of mixer 108 mm
- height up to aerator 94 mm
- hole diameter valve 32 mm
- hole diameter spout 35 mm
- rosette 60 x 47 mm
- 2x screw-in M 10 x 1 pressure hose, leak-tested
- max. flow 4 l/min
- lead-free
- This product can help a building meet the requirements of Green Building Rating Systems, e.g. LEED®, BREEAM®, DGNB

	Brushed Dark Platinum	ST 010 101 4705-99
	Chrome	ST 010 101 4705-00
	Brushed Platinum	ST 010 101 4705-06
	Dark Chrome	ST 010 101 4705-19
	Brushed Champagne (22kt Gold)	ST 010 101 4705-46
	Champagne (22kt Gold)	ST 010 101 4705-47

Individual components of this set

You need the following components for this set

1x 13 714 705-99



1x 20 004 705-99



1x 20 004 706-99







CL.1 Three-hole basin mixer without pop-up waste - Brushed Dark Platinum

CL.1

ST 010 101 4705

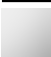
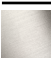

- 160mm projection
- fixed spout
- rectangular spray pattern with 40 individual jets
- height of mixer 108 mm
- height up to aerator 94 mm
- hole diameter 35 mm
- 2x screw-in M 10 x 1 pressure hose, leak-tested
- 1/2" connection
- max. flow 4 l/min
- lead-free
- This product can help a building meet the requirements of Green Building Rating Systems, e.g. LEED®, BREEAM®, DGNB
- WRAS 1512011

	Brushed Dark Platinum	13 714 705-9
	Chrome	13 714 705-0
	Brushed Platinum	13 714 705-0
	Dark Chrome	13 714 705-1
	Brushed Champagne (22kt Gold)	13 714 705-4
	Champagne (22kt Gold)	13 714 705-4



CL.1 Three-hole basin mixer without pop-up waste - Brushed Dark Platinum

CL.1

ST 010 101 4705

9
—
0
—
6
—
9
—
6
—
7
—

ST 010 101 4705

mm [inches]

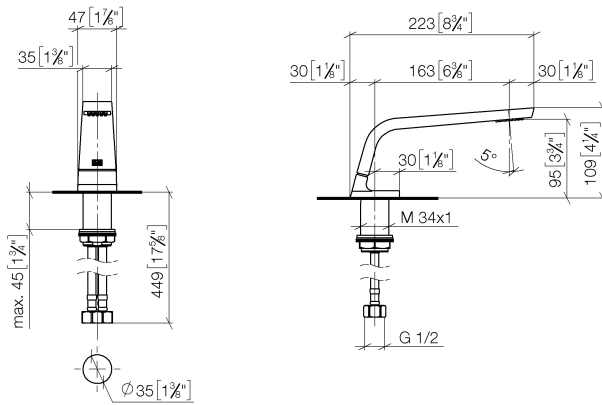

Flow rate chart

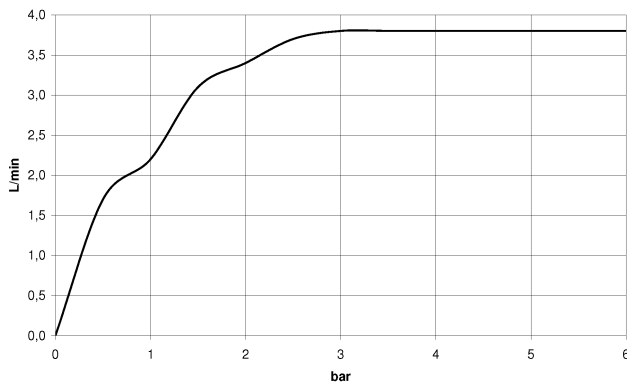

Certificates

LGA_28

IAPMO_4976

GDV_0400

IAPMO_N-4

IAPMO_8834

IAPMO_6

WRAS_1512

Codes & Standards

ASME A112.18.1	cUPC	DIN 4109	EPA WaterSense
Executive Order no. 1007	ISO 3822	NSF372	NSF61
Scottish Water Byelaws	UK Water Supply Regulations	Ü-Zeichen	WaterSense 

ST 010 101 4705

Product version from 6/15/2021

Product version from 7/1/2021 to 6/15/2021

Parts for other
finishes can be found
here: [Chrome](#)

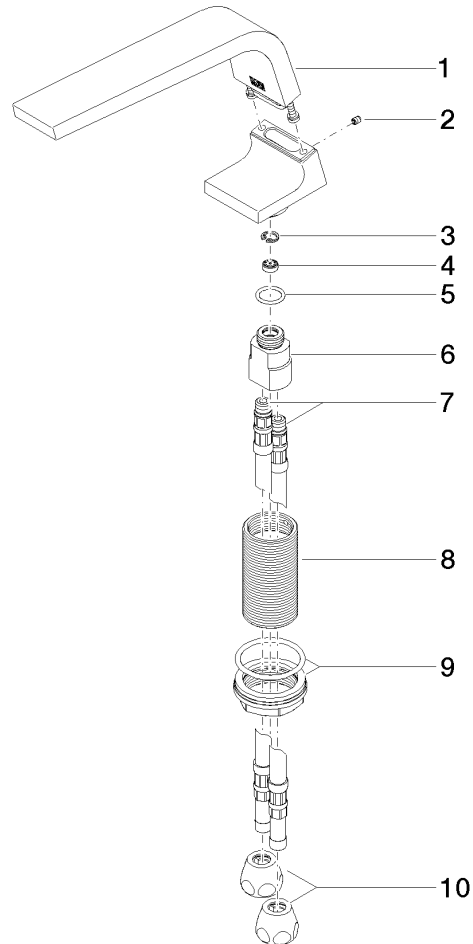



CL.1 Three-hole basin mixer without pop-up waste - Brushed Dark Platinum

CL.1

ST 010 101 4705

Spare parts list

Product version from 6/15/2021

Product version from 7/1/2021 to 6/15/2021

No.	Item Number	Name	Quantity used	Delivery time
	90 11 70 002 00-99	spout	12	30







CL.1 Three-hole basin mixer without pop-up waste - Brushed Dark Platinum

CL.1

ST 010 101 4705

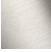

- hole diameter 32 mm
- rosette 60 x 47 mm
- with cold marking
- WRAS 240202020

	Brushed Dark Platinum	20 004 705-9
	Chrome	20 004 705-0
	Brushed Platinum	20 004 705-0
	Dark Chrome	20 004 705-1
	Brushed Champagne (22kt Gold)	20 004 705-4
	Champagne (22kt Gold)	20 004 705-4



CL.1 Three-hole basin mixer without pop-up waste - Brushed Dark Platinum

CL.1

ST 010 101 4705

9
—
0
—
6
—
9
—
6
—
7
—

ST 010 101 4705

mm [inches]

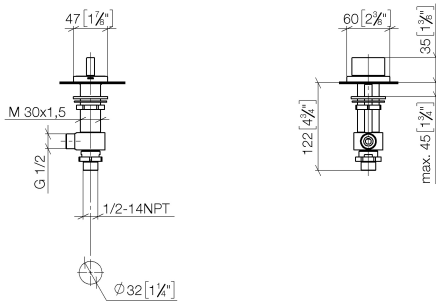

Flow rate chart

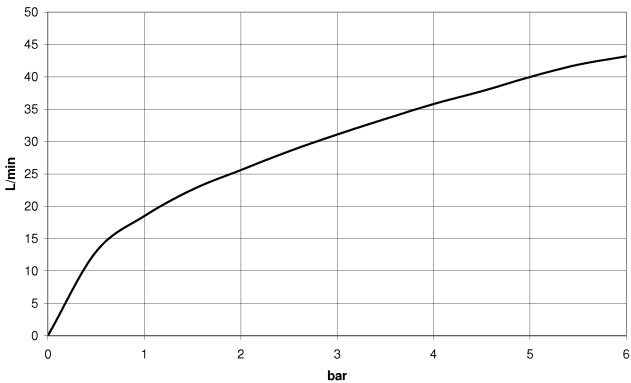

Certificates

WRAS_240202 IAPMO_N-4 WRAS_1804 LGA_28 IAPMO_6

IAPMO_4976



CL.1 Three-hole basin mixer without pop-up waste - Brushed Dark Platinum

CL.1

ST 010 101 4705

Codes & Standards

ASME A112.18.1	cUPC	DIN 4109	ISO 3822
NSF372	NSF61	Scottish Water Byelaws	UK Water Supply Regulations

Ü-Zeichen

Product version from 3/9/2015

Parts for other
finishes can be found
here: [Chrome](#)

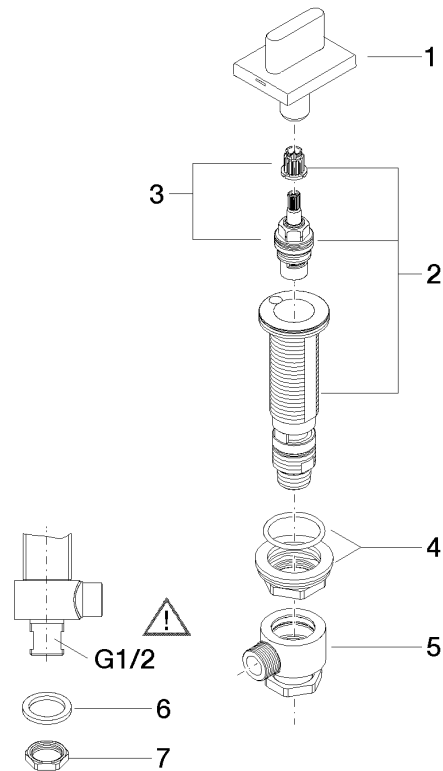

ST 010 101 4705

Spare parts list

Product version from 3/9/2015

No.	Item Number	Name	Quantity used	Delivery time
	90 20 70 051 06-99	handle (cold)	8	30







CL.1 Three-hole basin mixer without pop-up waste - Brushed Dark Platinum

CL.1

ST 010 101 4705



- hole diameter 32 mm
- rosette 60 x 47 mm
- with hot marking
- WRAS 240202020

	Brushed Dark Platinum	20 004 706-9
	Chrome	20 004 706-0
	Brushed Platinum	20 004 706-0
	Dark Chrome	20 004 706-1
	Brushed Champagne (22kt Gold)	20 004 706-4
	Champagne (22kt Gold)	20 004 706-4



CL.1 Three-hole basin mixer without pop-up waste - Brushed Dark Platinum

CL.1

ST 010 101 4705

9
—
0
—
6
—
9
—
6
—
7
—

ST 010 101 4705

mm [inches]

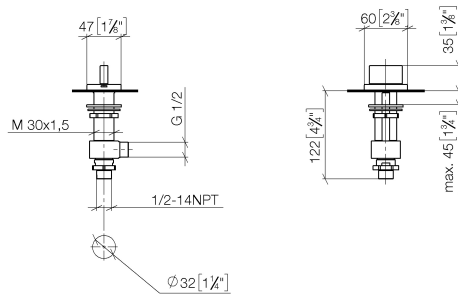

Flow rate chart

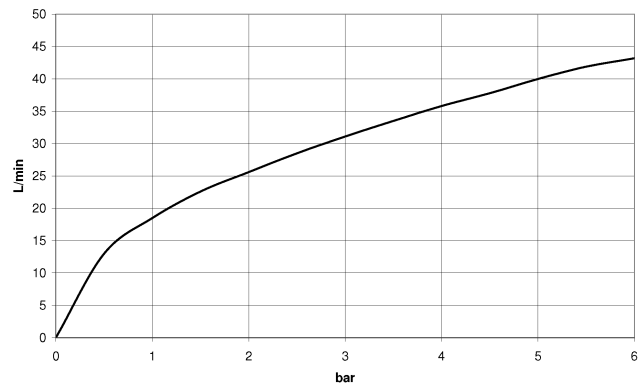

Certificates

IAPMO_4976 WRAS_240202 IAPMO_N-4 WRAS_1804 LGA_28

IAPMO_6

Codes & Standards

ASME A112.18.1	cUPC	DIN 4109	ISO 3822
----------------	------	----------	----------

NSF372	NSF61	Scottish Water Byelaws	UK Water Supply Regulations
--------	-------	---------------------------	--------------------------------

Ü-Zeichen

Product version from 3/9/2015

Parts for other
finishes can be found
here: [Chrome](#)

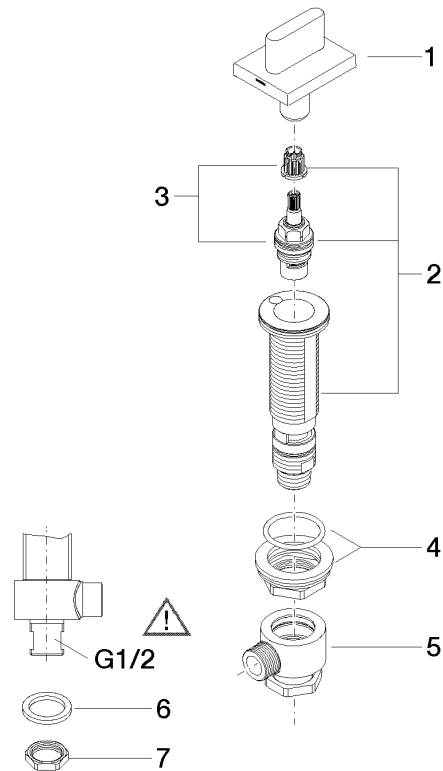



CL.1 Three-hole basin mixer without pop-up waste - Brushed Dark Platinum

CL.1

ST 010 101 4705

Spare parts list

Product version from 3/9/2015

No.	Item Number	Name	Quantity used	Delivery time
	90 20 70 051 07-99	handle (hot)	8	30