







CYO Two-hole basin mixer without pop-up waste - Brushed Dark Platinum

CYO

ST 010 108 5811



- 133mm projection
- fixed spout
- rectangular, air-enriched flow
- height of mixer 180 mm
- height up to aerator 128 mm
- hole diameter spout 35 mm
- hole diameter valve 32 mm
- handle Ø 60mm
- 2x screw-in M 8 x 1 pressure hose, leak-tested
- 1x screw-in M 10 x 1 pressure hose, leak-tested
- max. flow 4.5 l/min
- progressive cartridge
- lead-free
- with hot / cold marking
- This product can help a building meet the requirements of Green Building Rating Systems, e.g. LEED®, BREEAM®, DGNB

	Brushed Dark Platinum	ST 010 108 5811-99
	Chrome	ST 010 108 5811-00
	Brushed Platinum	ST 010 108 5811-06
	Dark Chrome	ST 010 108 5811-19
	Brushed Durabronz (23kt Gold)	ST 010 108 5811-28
	Platinum / Brushed Platinum	ST 010 108 5811-36
	Durabronz / Brushed Durabronz (23kt Gold)	ST 010 108 5811-38

Individual components of this set

You need the following components for this set

1x 29 217 811-99



1x 11 188 811-99



CYO Two-hole basin mixer without pop-up waste - Brushed Dark Platinum

CYO

ST 010 108 5811



- 133mm projection
- fixed spout
- rectangular, air-enriched flow
- height of mixer 180 mm
- height up to aerator 128 mm
- hole diameter spout 35 mm
- hole diameter valve 32 mm
- handle Ø 60mm
- 2x screw-in M 8 x 1 pressure hose, leak-tested
- 1x screw-in M 10 x 1 pressure hose, leak-tested
- max. flow 4.5 l/min
- progressive cartridge
- lead-free
- This product can help a building meet the requirements of Green Building Rating Systems, e.g. LEED®, BREEAM®, DGNB
- WRAS 2201012

NOTE: The handle inserts must be ordered separately from the fittings!

	Brushed Dark Platinum	29 217 811-9
	Chrome	29 217 811-0
	Brushed Platinum	29 217 811-0
	Dark Chrome	29 217 811-1
	Brushed Durabronze (23kt Gold)	29 217 811-2
	Platinum / Brushed Platinum	29 217 811-3
	Durabronze / Brushed Durabronze (23kt Gold)	29 217 811-3
	Brushed Bronze	29 217 811-4



CYO Two-hole basin mixer without pop-up waste - Brushed Dark Platinum

CYO

ST 010 108 5811

9
—
0
—
6
—
9
—
8
—
6
—
8
—
2
—

ST 010 108 5811

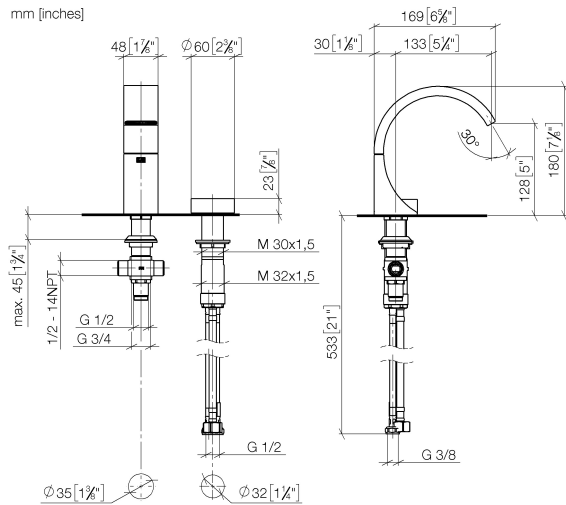

Flow rate chart

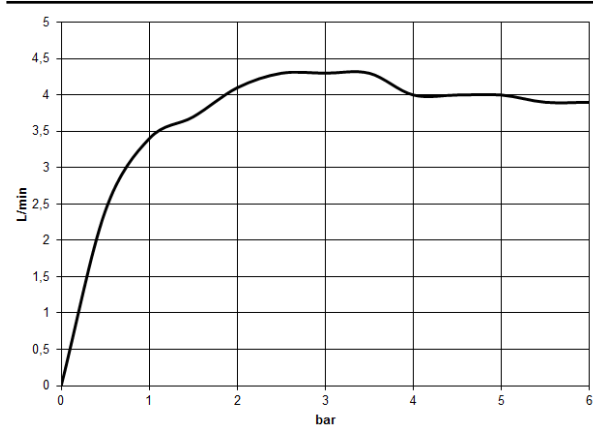

Certificates

LGA_38

WRAS_2201



CYO Two-hole basin mixer without pop-up waste - Brushed Dark Platinum

CYO

ST 010 108 5811

Codes & Standards

DIN 4109	ISO 3822	Scottish Water Byelaws	UK Water Supply Regulations
----------	----------	---------------------------	--------------------------------

Ü-Zeichen



CYO Two-hole basin mixer without pop-up waste - Brushed Dark Platinum

CYO

ST 010 108 5811

Parts for other
finishes can be found
here: [Chrome](#)

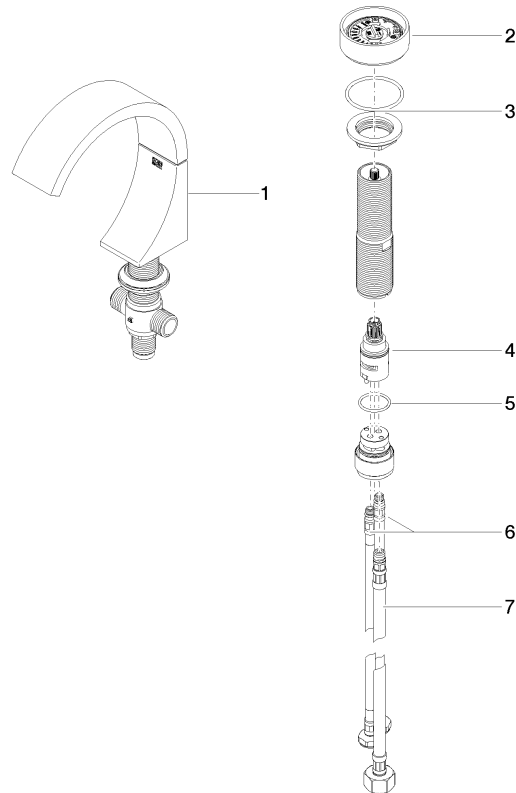



CYO Two-hole basin mixer without pop-up waste - Brushed Dark Platinum

CYO

ST 010 108 5811

Spare parts list

No.	Item Number	Name	Quantity used	Delivery time
	13 715 811-99	CYO Deck-mounted basin spout without pop-up waste - Brushed Dark Platinum	8	30







CYO Two-hole basin mixer without pop-up waste - Brushed Dark Platinum

CYO

ST 010 108 5811



- with hot / cold marking
- for two-hole basin mixer

	Brushed Dark Platinum	11 188 811-9
	Chrome	11 188 811-0
	Brushed Platinum	11 188 811-0
	Platinum	11 188 811-0
	Durabrand (23kt Gold)	11 188 811-0
	Dark Chrome	11 188 811-1
	Brushed Durabrand (23kt Gold)	11 188 811-2



CYO Two-hole basin mixer without pop-up waste - Brushed Dark Platinum

CYO

ST 010 108 5811

19
—
10
—
16
—
18
—
19
—
9
—
18
—

ST 010 108 5811

mm [inches]

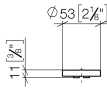



CYO Two-hole basin mixer without pop-up waste - Brushed Dark Platinum

CYO

ST 010 108 5811

Parts for other
finishes can be found
here: [Chrome](#)

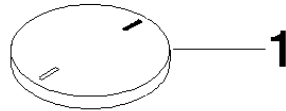

Spare parts list