

CL.1 Five-hole bath mixer for deck mounting with diverter - Brushed Champagne (22kt Gold)

CL.1

ST 030 100 2705



- 200mm projection
 - rectangular spray pattern with 55 individual jets
 - Hand shower: COMPACT RAIN, max. flow rate 6.8 l/min (at 3 bar)
 - complete hand shower set with anti-scale system
 - height of mixer 125 mm
 - height up to aerator 108 mm
 - 1/2" connection
 - hole diameter spout 35 mm
 - hole diameter valve 32 mm
 - rosette for complete hand shower set 60 x 60mm
 - rosette for deck valve 60 x 60mm
 - metal shower hose 2250mm with integrated anti-twist protection
- Intrinsic protection against back flow.**

	Brushed Champagne (22kt Gold)	ST 030 100 2705-46
	Chrome	ST 030 100 2705-00
	Brushed Platinum	ST 030 100 2705-06
	Dark Chrome	ST 030 100 2705-19
	Champagne (22kt Gold)	ST 030 100 2705-47
	Brushed Dark Platinum	ST 030 100 2705-99

Individual components of this set

You need the following components for this set

	1x	27 702 980-46		1x	29 140 670-46
	1x	13 612 705-46		1x	20 000 705-46
	1x	20 000 706-46			

**CL.1 Five-hole bath mixer for deck mounting with diverter - Brushed
Champagne (22kt Gold)**

CL.1

ST 030 100 2705



Fits: IMO, MEM, CL.1, CYO

- COMPACT RAIN, max. flow rate 6.8 l/min (at 3 bar)
- with anti-scale system
- rosette 60 x 60 mm
- hole diameter 32 mm
- metal shower hose 2250mm with integrated anti-twist protection
- WRAS 2209005

Two-piece design allows hose to later be changed without dismantling the fitting.

Intrinsic protection against back flow.

	Brushed Champagne (22kt Gold)	27 702 980-4
	Chrome	27 702 980-0
	Brushed Platinum	27 702 980-0
	Platinum	27 702 980-0
	Dark Chrome	27 702 980-1
	Brushed Light Gold	27 702 980-2
	Brushed Durabronze (23kt Gold)	27 702 980-2
	Matte Black	27 702 980-3
	Champagne (22kt Gold)	27 702 980-4
	Brushed Chrome	27 702 980-9
	Brushed Dark Platinum	27 702 980-9



CL.1 Five-hole bath mixer for deck mounting with diverter - Brushed
Champagne (22kt Gold)

CL.1

ST 030 100 2705

6
—
10
—
16
—
18
—
9
—
7
—
8
—
3
—
7
—
3
—
9
—

CL.1 Five-hole bath mixer for deck mounting with diverter - Brushed Champagne (22kt Gold)

CL.1

ST 030 100 2705
mm [inches]

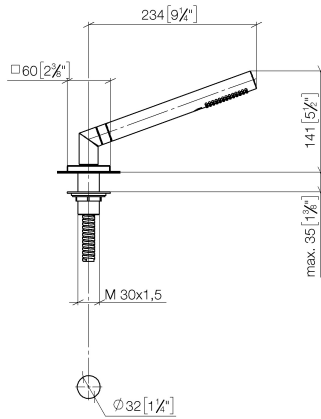

Flow rate chart

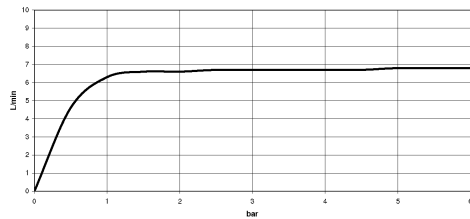

Certificates

Belgaqua_21-383-2 WRAS_2209



CL.1 Five-hole bath mixer for deck mounting with diverter - Brushed
Champagne (22kt Gold)

CL.1

ST 030 100 2705

Codes & Standards

EN 1717	Scottish Water Byelaws	UK Water Supply Regulations
---------	---------------------------	--------------------------------



CL.1 Five-hole bath mixer for deck mounting with diverter - Brushed Champagne (22kt Gold)

CL.1

ST 030 100 2705

CL.1 Five-hole bath mixer for deck mounting with diverter - Brushed Champagne (22kt Gold)

CL.1

ST 030 100 2705

Product version from 5/15/2020

Parts for other
finishes can be found
here: [Chrome](#)

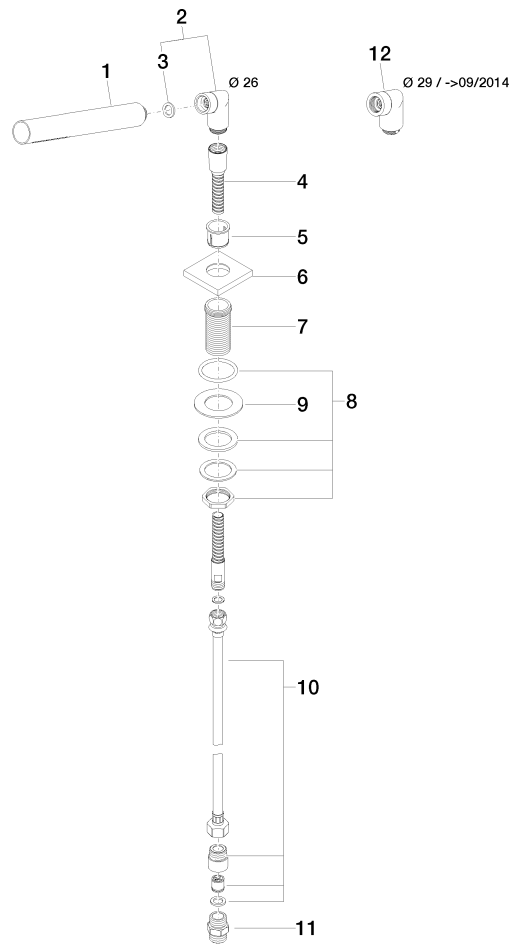



CL.1 Five-hole bath mixer for deck mounting with diverter - Brushed Champagne (22kt Gold)

CL.1

ST 030 100 2705

Spare parts list

Product version from 5/15/2020

No.	Item Number	Name	Quantity used	Delivery time
	90 12 11 140 30-46	shower	12	30

CL.1 Five-hole bath mixer for deck mounting with diverter - Brushed Champagne (22kt Gold)

CL.1

ST 030 100 2705

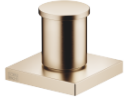

Fits: IMO, MEM, CYO

- automatic bath/shower diverter
- hole diameter 32 mm
- rosette 60 x 60 mm
- 1/2" connection
- max. flow 64.9 l/min at 3 bar flow pressure
- WRAS 1911025

	Brushed Champagne (22kt Gold)	29 140 670-4
	Chrome	29 140 670-0
	Brushed Platinum	29 140 670-0
	Platinum	29 140 670-0
	Dark Chrome	29 140 670-1
	Brushed Light Gold	29 140 670-2
	Brushed Durabronze (23kt Gold)	29 140 670-2
	Matte Black	29 140 670-3
	Champagne (22kt Gold)	29 140 670-4
	Brushed Chrome	29 140 670-9
	Brushed Dark Platinum	29 140 670-9

CL.1 Five-hole bath mixer for deck mounting with diverter - Brushed
Champagne (22kt Gold)

CL.1

ST 030 100 2705

6
—
10
—
16
—
18
—
9
—
7
—
8
—
3
—
7
—
3
—
9
—

CL.1 Five-hole bath mixer for deck mounting with diverter - Brushed Champagne (22kt Gold)

CL.1

ST 030 100 2705
mm [inches]

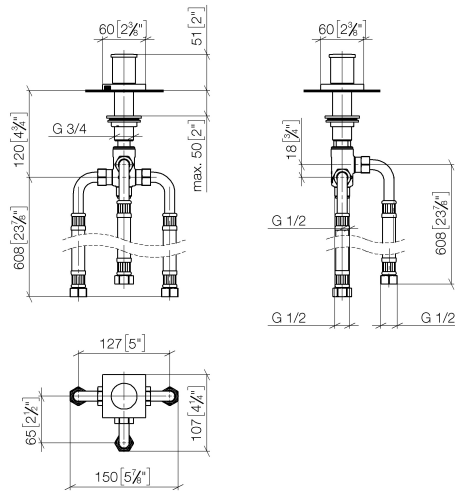

Flow rate chart

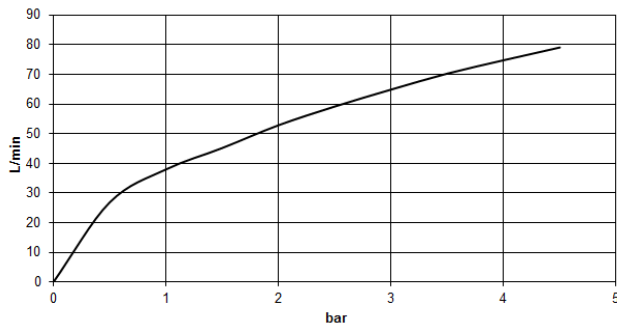



CL.1 Five-hole bath mixer for deck mounting with diverter - Brushed Champagne (22kt Gold)

CL.1

ST 030 100 2705

**CL.1 Five-hole bath mixer for deck mounting with diverter - Brushed
Champagne (22kt Gold)**

CL.1

ST 030 100 2705

Product version from 6/30/2015

Parts for other
finishes can be found
here: [Chrome](#)

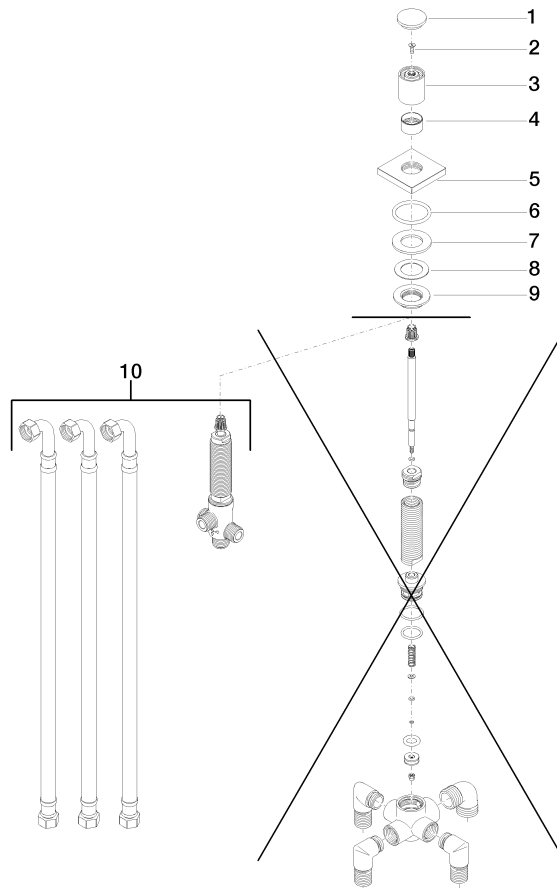

CL.1 Five-hole bath mixer for deck mounting with diverter - Brushed Champagne (22kt Gold)







CL.1

ST 030 100 2705

Spare parts list

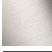
Product version from 6/30/2015



<ul style="list-style-type: none"> • 200mm projection • rectangular spray pattern with 55 individual jets • height of mixer 125 mm • height up to aerator 108 mm • hole diameter 35 mm • 1/2" connection • max. flow 24.6 l/min at 3 bar flow pressure • WRAS 1512010 	<div>  <div> <div>Brushed Champagne (22kt Gold)</div> <div>13 612 705-4</div> </div> </div>
	<div>  <div> <div>Chrome</div> <div>13 612 705-0</div> </div> </div>
	<div>  <div> <div>Brushed Platinum</div> <div>13 612 705-0</div> </div> </div>
	<div>  <div> <div>Dark Chrome</div> <div>13 612 705-1</div> </div> </div>
	<div>  <div> <div>Champagne (22kt Gold)</div> <div>13 612 705-4</div> </div> </div>
	<div>  <div> <div>Brushed Dark Platinum</div> <div>13 612 705-9</div> </div> </div>



CL.1 Five-hole bath mixer for deck mounting with diverter - Brushed
Champagne (22kt Gold)

CL.1

ST 030 100 2705

6
—
10
—
16
—
9
—
7
—
9
—

CL.1 Five-hole bath mixer for deck mounting with diverter - Brushed Champagne (22kt Gold)

CL.1

ST 030 100 2705
mm [inches]

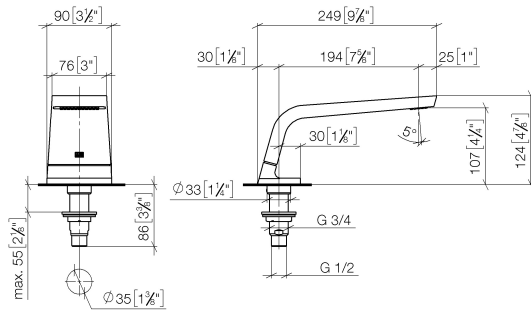

Flow rate chart

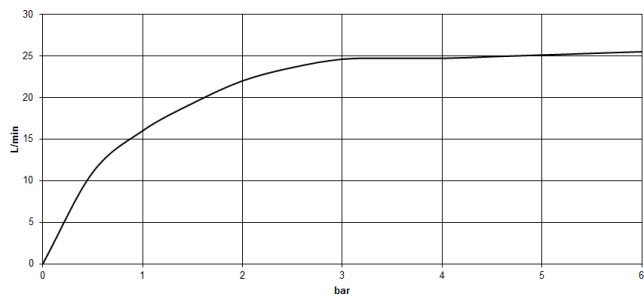

CL.1 Five-hole bath mixer for deck mounting with diverter - Brushed
Champagne (22kt Gold)

CL.1

ST 030 100 2705

CL.1 Five-hole bath mixer for deck mounting with diverter - Brushed Champagne (22kt Gold)

CL.1

ST 030 100 2705

Product version from 5/27/2021

Parts for other
finishes can be found
here: [Chrome](#)

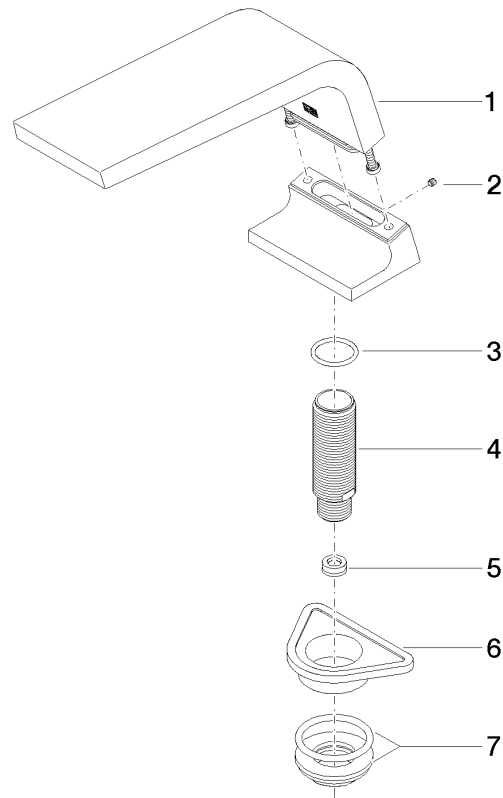



CL.1 Five-hole bath mixer for deck mounting with diverter - Brushed
Champagne (22kt Gold)

CL.1

ST 030 100 2705

Spare parts list

Product version from 5/27/2021

No.	Item Number	Name	Quantity used	Delivery time
	90 11 70 007 00-46	spout	7	30







CL.1 Five-hole bath mixer for deck mounting with diverter - Brushed
Champagne (22kt Gold)

CL.1

ST 030 100 2705



- hole diameter valve 32 mm
- rosette 60 x 60 mm
- with cold marking
- WRAS 2103001

	Brushed Champagne (22kt Gold)	20 000 705-4
	Chrome	20 000 705-0
	Brushed Platinum	20 000 705-0
	Dark Chrome	20 000 705-1
	Champagne (22kt Gold)	20 000 705-4
	Brushed Dark Platinum	20 000 705-9

CL.1 Five-hole bath mixer for deck mounting with diverter - Brushed
Champagne (22kt Gold)

CL.1

ST 030 100 2705

6
—
10
—
16
—
9
—
.7
—
19
—

CL.1 Five-hole bath mixer for deck mounting with diverter - Brushed Champagne (22kt Gold)

CL.1

ST 030 100 2705
mm [inches]

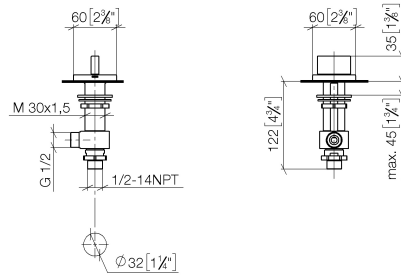

Flow rate chart

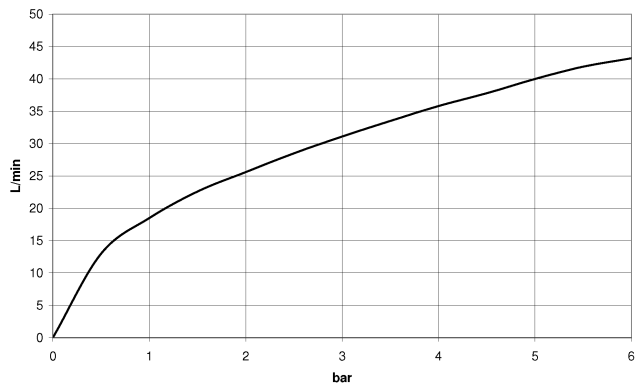

Certificates

WRAS_2103



CL.1 Five-hole bath mixer for deck mounting with diverter - Brushed
Champagne (22kt Gold)

CL.1

ST 030 100 2705

Codes & Standards

Scottish Water Byelaws	UK Water Supply Regulations
---------------------------	--------------------------------

CL.1 Five-hole bath mixer for deck mounting with diverter - Brushed
Champagne (22kt Gold)

CL.1

ST 030 100 2705

CL.1 Five-hole bath mixer for deck mounting with diverter - Brushed Champagne (22kt Gold)

CL.1

ST 030 100 2705

Product version from 3/9/2015

Parts for other
finishes can be found
here: [Chrome](#)

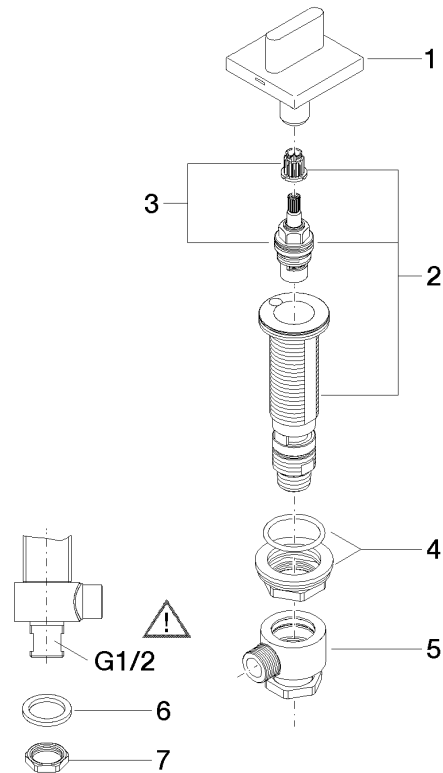



CL.1 Five-hole bath mixer for deck mounting with diverter - Brushed Champagne (22kt Gold)

CL.1

ST 030 100 2705

Spare parts list

Product version from 3/9/2015

No.	Item Number	Name	Quantity used	Delivery time
	90 20 70 051 04-46	handle (cold)	8	30







CL.1 Five-hole bath mixer for deck mounting with diverter - Brushed
Champagne (22kt Gold)

CL.1

ST 030 100 2705



- hole diameter valve 32 mm
- rosette 60 x 60 mm
- with hot marking
- WRAS 2103001

	Brushed Champagne (22kt Gold)	20 000 706-4
	Chrome	20 000 706-0
	Brushed Platinum	20 000 706-0
	Dark Chrome	20 000 706-1
	Champagne (22kt Gold)	20 000 706-4
	Brushed Dark Platinum	20 000 706-9



CL.1 Five-hole bath mixer for deck mounting with diverter - Brushed
Champagne (22kt Gold)

CL.1

ST 030 100 2705

6
—
10
—
16
—
9
—
.7
—
19
—

CL.1 Five-hole bath mixer for deck mounting with diverter - Brushed Champagne (22kt Gold)

CL.1

ST 030 100 2705
mm [inches]

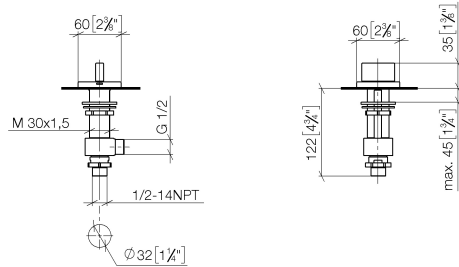

Flow rate chart

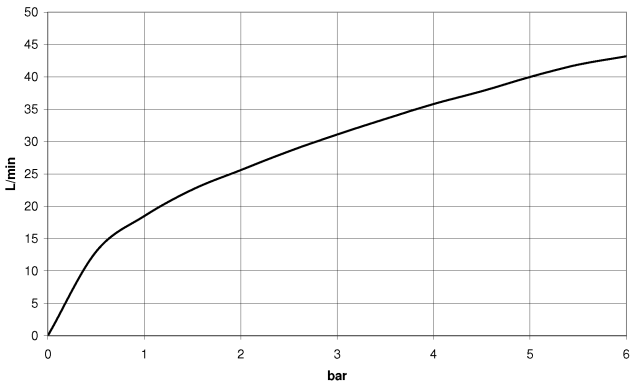

Certificates

WRAS_2103



CL.1 Five-hole bath mixer for deck mounting with diverter - Brushed
Champagne (22kt Gold)

CL.1

ST 030 100 2705

Codes & Standards

Scottish Water Byelaws	UK Water Supply Regulations
---------------------------	--------------------------------



CL.1 Five-hole bath mixer for deck mounting with diverter - Brushed Champagne (22kt Gold)

CL.1

ST 030 100 2705

CL.1 Five-hole bath mixer for deck mounting with diverter - Brushed Champagne (22kt Gold)

CL.1

ST 030 100 2705

Product version from 3/9/2015

Parts for other
finishes can be found
here: [Chrome](#)

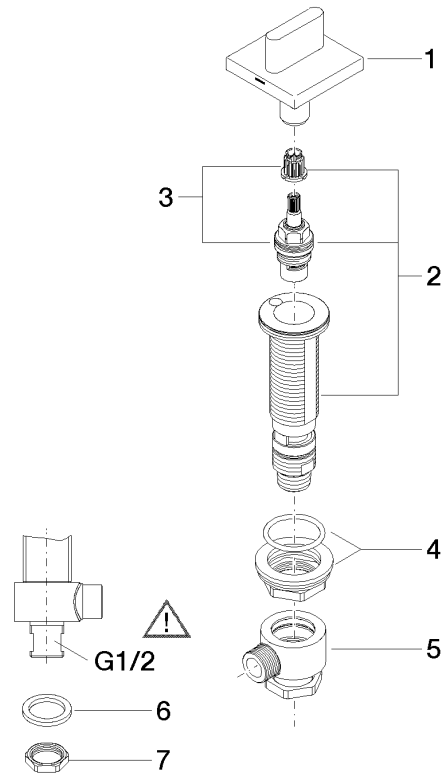



CL.1 Five-hole bath mixer for deck mounting with diverter - Brushed
Champagne (22kt Gold)

CL.1

ST 030 100 2705

Spare parts list
Product version from 3/9/2015

No.	Item Number	Name	Quantity used	Delivery time
	90 20 70 051 05-46	handle (hot)	8	30