

META xTOOL Thermostat module with 3 valves - Champagne (22kt Gold)

META

ST 060 115 6660



- cover plate Ø 123 mm
- rosette Ø 60 mm
- temperature control handle with safety limit stop at 38°C
- thermostat cartridge
- 3x head part with cut-to-length spindle and sleeve

	Champagne (22kt Gold)	ST 060 115 6660-47
	Chrome	ST 060 115 6660-00
	Brushed Platinum	ST 060 115 6660-06
	Dark Chrome	ST 060 115 6660-19
	Light Gold	ST 060 115 6660-26
	Brushed Light Gold	ST 060 115 6660-27
	Matte Black	ST 060 115 6660-33
	Brushed Bronze	ST 060 115 6660-42
	Brushed Champagne (22kt Gold)	ST 060 115 6660-46
	Brushed Chrome	ST 060 115 6660-93
	Brushed Dark Platinum	ST 060 115 6660-99

Individual components of this set

You need the following components for this set

1x 36 503 979-47



3x 36 607 661-47



ST 060 115 6660

Error: Subreport could not be shown.

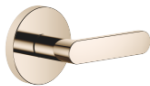

- rosette Ø 60 mm
- head part with cut-to-length spindle and sleeve

	Champagne (22kt Gold)	36 607 661-4
	Chrome	36 607 661-0
	Brushed Platinum	36 607 661-0
	Dark Chrome	36 607 661-1
	Light Gold	36 607 661-2
	Brushed Light Gold	36 607 661-2
	Matte Black	36 607 661-3
	Brushed Bronze	36 607 661-4
	Brushed Champagne (22kt Gold)	36 607 661-4
	Brushed Chrome	36 607 661-9
	Brushed Dark Platinum	36 607 661-9

ST 060 115 6660

.7  
—  
10  
—  
16  
—  
9  
—  
16  
—  
17  
—  
13  
—  
2  
—  
6  
—  
13  
—  
19  
—

Required miscellaneous



- Wall valve 1/2" -**
- max. recess depth 145 mm
  - min. recess depth 85 mm

35 607 970 90

Required miscellaneous



- Wall valve 1/2" -**
- max. recess depth 145 mm
  - min. recess depth 85 mm

35 607 970 90

ST 060 115 6660

mm [inches]

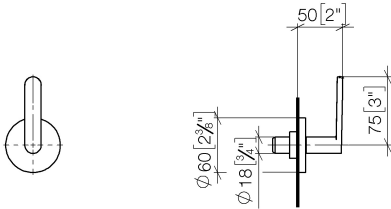

Certificates

IAPMO_4976	WRAS_2010	LGA_38	LGA_29	LGA_29
------------	-----------	--------	--------	--------

Codes & Standards

ASME A112.18.1

cUPC

DIN 4109

ISO 3822

Scottish Water  
Byelaws

UK Water Supply  
Regulations

Ü-Zeichen

**Product version from 7/1/2023**

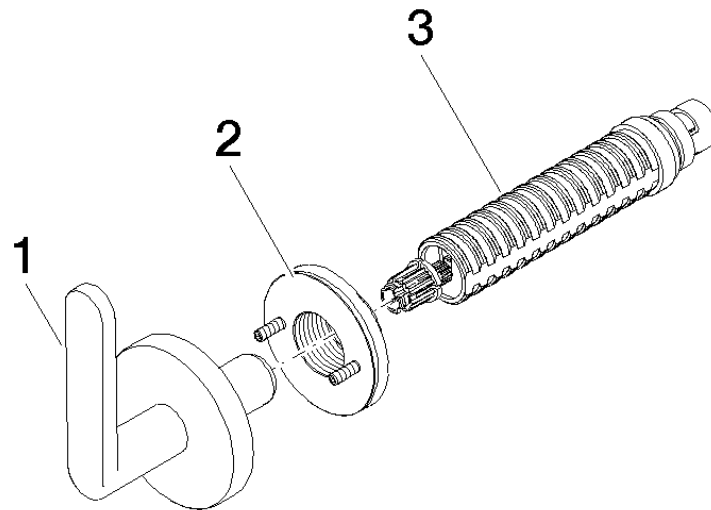



META xTOOL Thermostat module with 3 valves - Champagne (22kt Gold)

META

ST 060 115 6660

**Spare parts list**

**Product version from 7/1/2023**

No.	Item Number	Name	Quantity used	Delivery time
	90 20 66 014 04-47	handle	3	30