

## META Bath spout for wall mounting - Brushed Champagne (22kt Gold)

META

13 801 660 Product version from 5/28/2021



- 200mm projection
- circular normal flow
- rosette Ø 60 mm
- hole diameter 37 mm
- 1/2" connection
- max. flow 24.6 l/min at 3 bar flow pressure
- WRAS

	Brushed Champagne (22kt Gold)	13 801 660-46
	Chrome	13 801 660-00
	Brushed Platinum	13 801 660-06
	Dark Chrome	13 801 660-19
	Light Gold	13 801 660-26
	Brushed Light Gold	13 801 660-27
	Matte Black	13 801 660-33
	Brushed Bronze	13 801 660-42
	Champagne (22kt Gold)	13 801 660-47
	Brushed Chrome	13 801 660-93
	Brushed Dark Platinum	13 801 660-99

mm [inches]

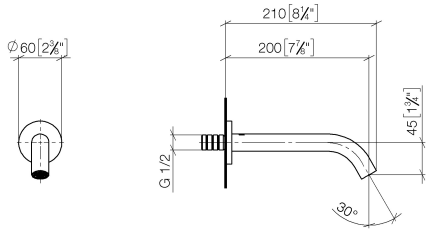

Flow rate chart

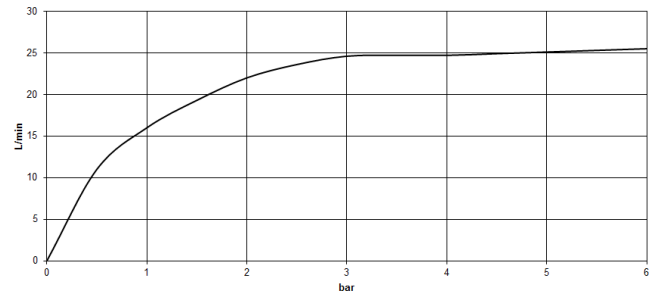

### Codes & Standards

ASME A112.18.1	cUPC	Scottish Water Byelaws	UK Water Supply Regulations
----------------	------	---------------------------	--------------------------------



## META Bath spout for wall mounting - Brushed Champagne (22kt Gold)

---

META

13 801 660 Product version from 5/28/2021

### Certificates and sustainability

---

IAPMO\_4976

WRAS\_250402

## META Bath spout for wall mounting - Brushed Champagne (22kt Gold)

META

13 801 660 Product version from 5/28/2021

Parts for other  
finishes can be found  
here: [Chrome](#)

