

MADISON Rain shower with wall fixing FlowReduce 200 mm - Brushed Platinum

MADISON

28 544 977









- rain shower Ø 200 mm
- rain flow
- max. flow 7 l/min
- Function from: 6.5 l/min
- with anti-scale system

Technical dimensions:

- 435mm projection
- rosette Ø 55 mm
- 1/2" connection

Notes:

- This product can help a building meet the requirements of Green Building Rating Systems, e.g. LEED®, BREEAM®, DGNB

|   |                               |               |
|---|-------------------------------|---------------|
|  | Brushed Platinum              | 28 544 977-06 |
|  | Chrome                        | 28 544 977-00 |
|  | Platinum                      | 28 544 977-08 |
|  | Durabrand (23kt Gold)         | 28 544 977-09 |
|  | Brushed Durabrand (23kt Gold) | 28 544 977-28 |
|  | Brushed Dark Platinum         | 28 544 977-99 |

## MADISON Rain shower with wall fixing FlowReduce 200 mm - Brushed Platinum

MADISON

28 544 977  
mm [inches]

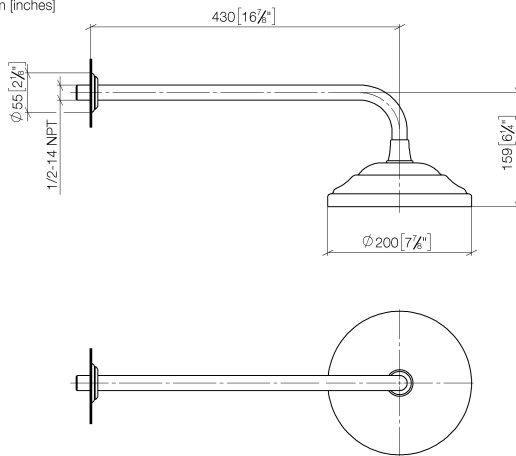

### Flow rate chart

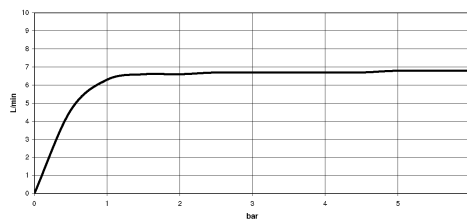

### Codes & Standards

DIN 4109

ISO 3822

Scottish Water  
Byelaws

UK Water Supply  
Regulations

Ü-Zeichen



MADISON Rain shower with wall fixing FlowReduce 200 mm - Brushed  
Platinum

MADISON

28 544 977  
Certificates and sustainability

LGA\_38

WRAS\_250102

28 544 977

Parts for other finishes can be found here: [Chrome](#)

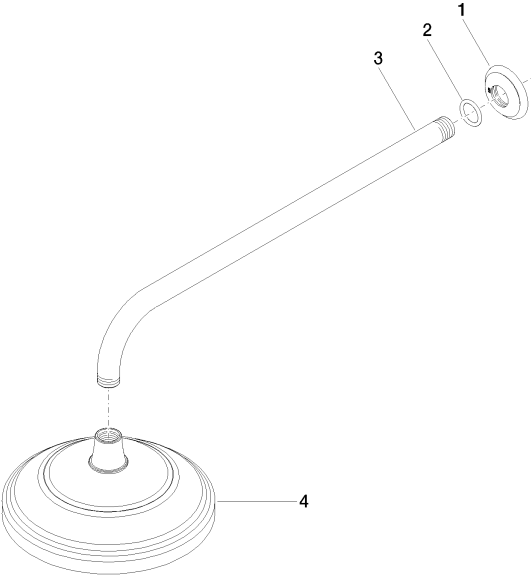

Spare parts list

| No. | Item Number        | Name       | Quantity used | Delivery time |
|-----|--------------------|------------|---------------|---------------|
| 1   | 09 27 35 003-06    | rosette    | 1.00          | 10            |
| 2   | 90 14 10 026 00 90 | seal       | 1.00          | 2             |
| 4   | 90 12 05 038 20-06 | shower     | 1.00          | 10            |
| 3   | 09 11 03 017-06    | connection | 1.00          | 10            |