









- rain shower Ø 200 mm
- rain flow
- max. flow 7 l/min
- Function from: 6.5 l/min
- with anti-scale system

**Technical data:**

- distance between ceiling and lower edge of the shower 185mm
- rosette Ø 55 mm
- 1/2" connection

**Notes:**

- This product can help a building meet the requirements of Green Building Rating Systems, e.g. LEED®, BREEAM®, DGNB

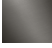
	Platinum	28 564 977-08
	Chrome	28 564 977-00
	Brushed Platinum	28 564 977-06
	Durabrand (23kt Gold)	28 564 977-09
	Brushed Durabrand (23kt Gold)	28 564 977-28
	Brushed Dark Brass	28 564 977-39
	Brushed Dark Platinum	28 564 977-99

mm [inches]

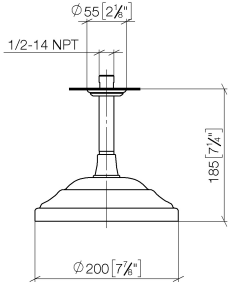

### Flow rate chart



### Codes & Standards

DIN 4109	ISO 3822	Scottish Water Byelaws	UK Water Supply Regulations
----------	----------	------------------------	-----------------------------

### Ü-Zeichen



## MADISON Rain shower with ceiling fixing FlowReduce 200 mm - Platinum

MADISON

28 564 977 Product version from 7/1/2025

Certificates and sustainability

LGA\_38

WRAS\_250102

Parts for other finishes can be found here: [Chrome](#)

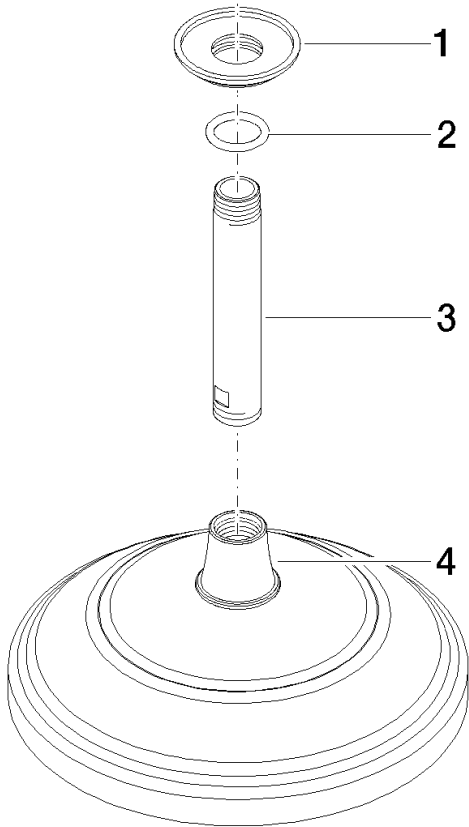

### Spare parts list

No.	Item Number	Name	Quantity used	Delivery time
2	90 14 10 026 00 90	seal	1.00	2
3	09 11 03 018-08	connection	1.00	40
4	90 12 05 038 20-08	shower	1.00	40
1	09 27 35 003-08	rosette	1.00	40