

**MADISON Rain shower with ceiling fixing FlowReduce 200 mm - Brushed
Durabrass (23kt Gold)**

MADISON

28 564 977 Product version from 7/1/2025







- rain shower Ø 200 mm
- rain flow
- max. flow 7 l/min
- Function from: 6.5 l/min
- with anti-scale system

Technical data:

- distance between ceiling and lower edge of the shower 185mm
- rosette Ø 55 mm
- 1/2" connection

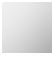
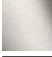
Notes:

- This product can help a building meet the requirements of Green Building Rating Systems, e.g. LEED®, BREEAM®, DGNB

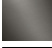
	Brushed Durabrass (23kt Gold)	28 564 977-28
	Chrome	28 564 977-00
	Brushed Platinum	28 564 977-06
	Platinum	28 564 977-08
	Durabrass (23kt Gold)	28 564 977-09
	Brushed Dark Brass	28 564 977-39
	Brushed Dark Platinum	28 564 977-99

**MADISON Rain shower with ceiling fixing FlowReduce 200 mm - Brushed
Durabron (23kt Gold)**

MADISON

28 564 977 Product version from 7/1/2025
mm [inches]

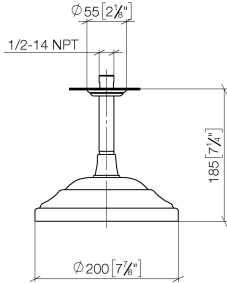

Flow rate chart



Codes & Standards

DIN 4109	ISO 3822	Scottish Water Byelaws	UK Water Supply Regulations
----------	----------	---------------------------	--------------------------------

Ü-Zeichen



MADISON Rain shower with ceiling fixing FlowReduce 200 mm - Brushed Durabrass (23kt Gold)

MADISON

28 564 977 Product version from 7/1/2025

Certificates and sustainability

LGA_38

WRAS_250102

MADISON Rain shower with ceiling fixing FlowReduce 200 mm - Brushed Durabrand (23kt Gold)

MADISON

28 564 977 Product version from 7/1/2025
Parts for other
finishes can be found
here: Chrome

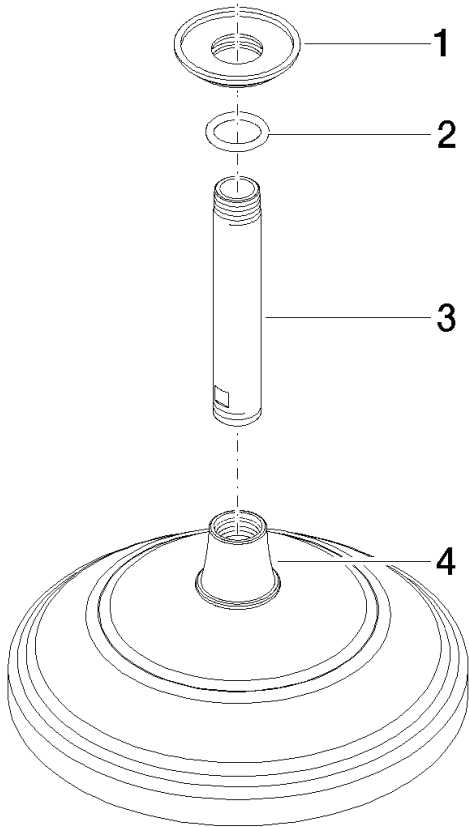

Spare parts list

No.	Item Number	Name	Quantity used	Delivery time
2	90 14 10 026 00 90	seal	1.00	2
3	09 11 03 018-28	connection	1.00	60
4	90 12 05 038 20-28	shower	1.00	20
1	09 27 35 003-28	rosette	1.00	60