

## Single sink - Brushed Stainless Steel

---

38 550 004



- under-mounted
- 550 x 400 mm
- sink depth 175 mm
- suitable for base units 600 mm
- Radius 15 mm

Drain and overflow set not included in the scope of supply. See Required miscellaneous.

## Single sink - Brushed Stainless Steel

---

38 550 004

mm [inches]  
1:10

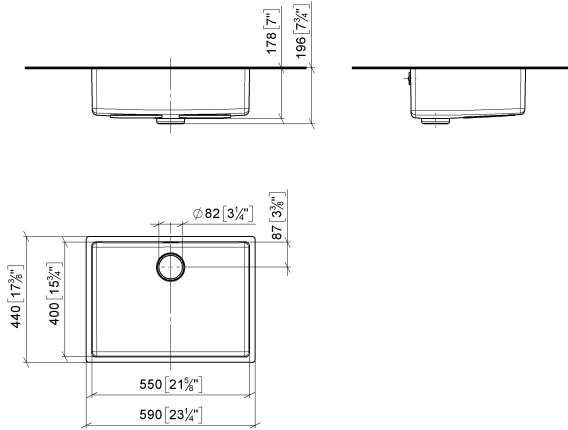

### Certificates

---

Leistungserklärung\_ declaration\_of\_perfo  
DOD rmance\_DOD