

Single sink - Brushed Stainless Steel

38 551 004



- installation, on top or flush
- 550 x 400 mm
- sink depth 175 mm
- suitable for base units 600 mm
- Radius 15 mm

Drain and overflow set not included in the scope of supply. See Required miscellaneous.

Single sink - Brushed Stainless Steel

38 551 004

mm [inches]
1:10

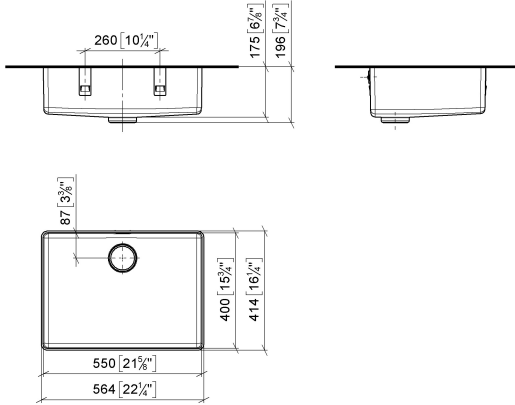

Certificates

Leistungserklärung_ declaration_of_perfo
DOD rmance_DOD