







SERENITY SKY Rain panel for recessed ceiling installation - Chrome

SERIES-VARIOUS

41 770 979 Product version from 9/1/2024



- exposed trim parts
- Rain panel with 2 different spray modes
- PURIFY RAIN, 175 x 175 mm, max. flow rate 10 l/min (at 3 bar)
- FULL RAIN, 455 x 315 mm, max. flow rate 14 l/min (at 3 bar)
- Rain panel, 600 x 420 mm
- min. recess depth 150 mm
- weight 15kg
- feed pipe (hot/cold): 2x DN 20
- with anti-scale system
- Recommended control element: xTool
- Not suitable for use in a steam room.

| | | |
|---|-------------------------------|---------------|
|  | Chrome | 41 770 979-00 |
|  | Dark Chrome | 41 770 979-19 |
|  | Brushed Bronze | 41 770 979-42 |
|  | Brushed Champagne (22kt Gold) | 41 770 979-46 |
|  | Champagne (22kt Gold) | 41 770 979-47 |
|  | Brushed Stainless Steel | 41 770 979-86 |
|  | Brushed Dark Platinum | 41 770 979-99 |

Required miscellaneous



- SERENITY SKY Concealed ceiling 35 770 970 90
- installation box -
- concealed rough parts
 - 2x female thread 1/2" connections
 - flush-mounted reflection box, 662 x 482 mm, RAL 9003, Signal White
 - min. recess depth 150 mm
 - weight 15kg
 - Recommended control element: xTool

41 770 979 Product version from 9/1/2024

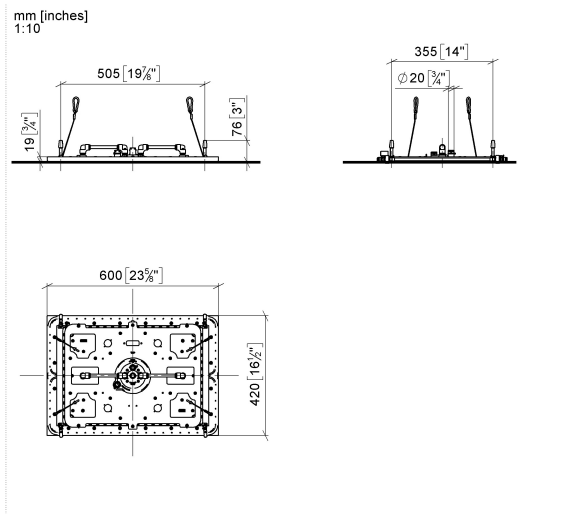

Flow rate chart

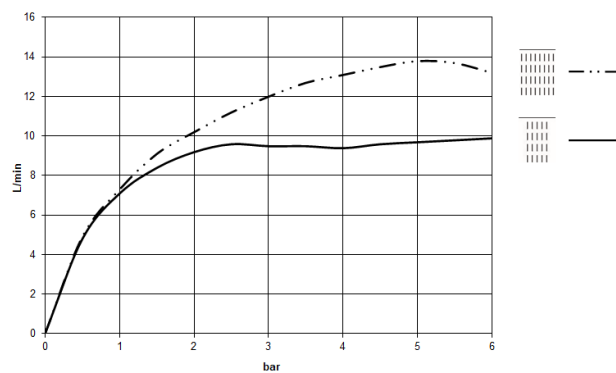

Codes & Standards

DIN 4109

ISO 3822

Scottish Water
Byelaws

UK Water Supply
Regulations

Ü-Zeichen



SERENITY SKY Rain panel for recessed ceiling installation - Chrome

SERIES-VARIOUS

41 770 979 Product version from 9/1/2024

Certificates and sustainability

LGA_38

WRAS_250102

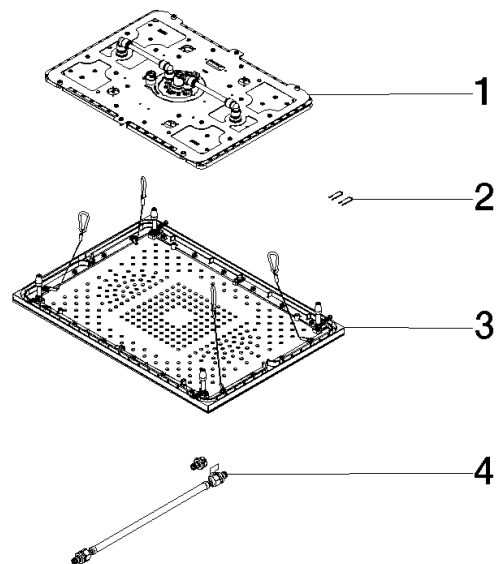

Spare parts list

| No. | Item Number | Name | Quantity used | Delivery time |
|-----|--------------------|--------|---------------|---------------|
| 3 | 90 12 05 106 00-00 | cover | 1.00 | 10 |
| 2 | 91 16 02 053 00 90 | holder | 1.00 | 2 |
| 1 | 90 12 01 095 02 90 | shower | 1.00 | 2 |
| 4 | 90 30 04 033 00 90 | hose | 1.00 | 2 |