

MADISON Raccordo curvo - Platinato







MADISON

28 450 410 Versione del prodotto fino a 06/07/2018

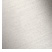

- uscita doccetta 1/2"
- rosetta Ø 55 mm
- ingresso 1/2"

Sistema di sicurezza antiriflusso.

	Platinato	28 450 410-08
	Cromato	28 450 410-00
	Platinato spazzolato	28 450 410-06
	Ottone (Oro 23k)	28 450 410-09
	Ottone spazzolato (Oro 23k)	28 450 410-28
	Dark Platinum spazzolato	28 450 410-99

Prodotti complementari



raccordo angolare ad incasso - 35 085 970 90

- Profondità d'incasso max. 163 mm
- profondità d'incasso min. 90 mm



Diagramma di portata



Codes & Standards

EN 1717	Scottish Water Byelaws	UK Water Supply Regulations
---------	---------------------------	--------------------------------

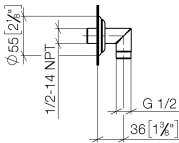
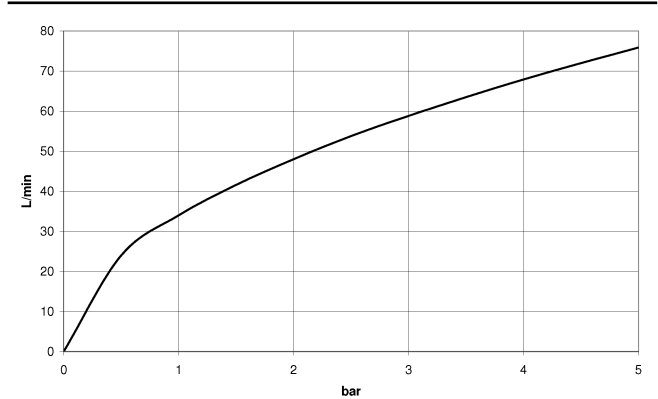

MADISON Raccordo curvo - Platinato

MADISON

28 450 410 Versione del prodotto fino a 06/07/2018

Certificati e sostenibilità

Belgaqua_21-381-2 WRAS_240502

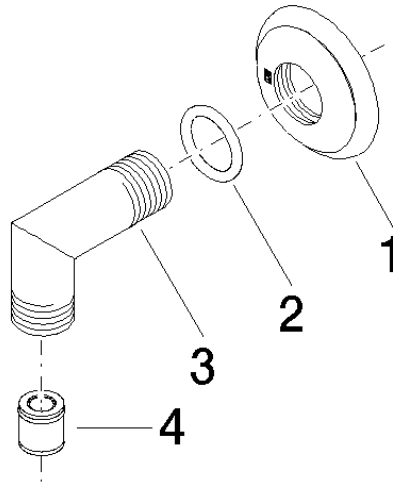

Elenco delle parti di ricambio

N.	Codice articolo	Denominazione	Quantità necessaria	Tempo di produzione
1	09 27 35 003-08	rosetta	1,00	40
3	09 11 03 121-08	attacco	1,00	40
2	90 14 10 026 00 90	guarnizione	1,00	2
4	90 23 01 141 00 90	valvola di non ritorno	1,00	2