







28 450 410

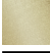

- uscita doccetta 1/2"
- rosetta Ø 55 mm
- ingresso 1/2"

Sistema di sicurezza antiriflusso.

|                                                                                   |                                |               |
|-----------------------------------------------------------------------------------|--------------------------------|---------------|
|  | Cromato                        | 28 450 410-00 |
|  | Platinato<br>spazzolato        | 28 450 410-06 |
|  | Platinato                      | 28 450 410-08 |
|  | Ottone (Oro 23k)               | 28 450 410-09 |
|  | Ottone spazzolato<br>(Oro 23k) | 28 450 410-28 |
|  | Dark Platinum<br>spazzolato    | 28 450 410-99 |

**Prodotti complementari**

**raccordo angolare ad incasso - 35 085 970 90**



- Profondità d'incasso max. 163 mm
- profondità d'incasso min. 90 mm

28 450 410

mm [inches]

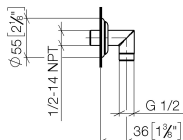

**Diagramma di portata**

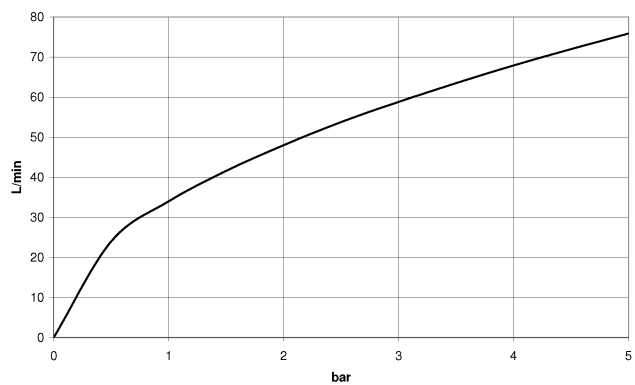

**Certificati**

Belgaqua\_21-381- WRAS\_240502026.  
27\_7.

28 450 410

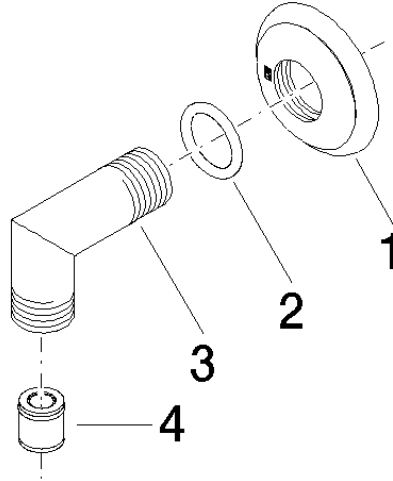

### Elenco delle parti di ricambio

| N. | Codice articolo    | Denominazione          | Quantità necessaria | Tempo di produzione |
|----|--------------------|------------------------|---------------------|---------------------|
| 1  | 09 27 35 003-00    | rosetta                | 1                   | 10                  |
| 2  | 90 14 10 026 00 90 | guarnizione            | 1                   | 2                   |
| 3  | 09 11 03 121-00    | attacco                | 1                   | 10                  |
| 4  | 90 23 01 141 00 90 | valvola di non ritorno | 1                   | 2                   |