







MEM Bath spout without diverter for free-standing assembly - Brushed Durabrass (23kt Gold)
MEM

13 672 780	Product version from 9/30/2005		
	<ul style="list-style-type: none"> • 280mm projection • cascade • total height 830 - 900 mm • height up to aerator 665 – 735 mm • push-on rosette 130 x 130 mm • max. flow 47.8 l/min at 3 bar flow pressure • WRAS 	 Brushed Durabrass (23kt Gold) 13 672 780-28	
		 Chrome 13 672 780-00	
		 Brushed Platinum 13 672 780-06	
		 Platinum 13 672 780-08	
		 Dark Chrome 13 672 780-19	
		 Brushed Champagne (22kt Gold) 13 672 780-46	
		 Champagne (22kt Gold) 13 672 780-47	

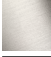
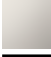
Required miscellaneous

	Concealed floor mounting - • max. recess depth 150 mm • min. recess depth 80 mm	35 945 970 90
---	--	---------------

MEM Bath spout without diverter for free-standing assembly - Brushed Durabron (23kt Gold)

MEM

13 672 780 Product version from 9/30/2005
mm [inches]

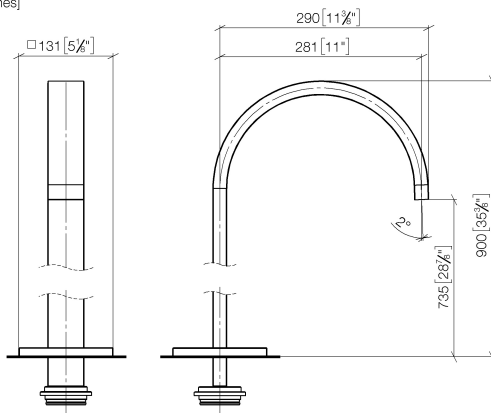

Flow rate chart

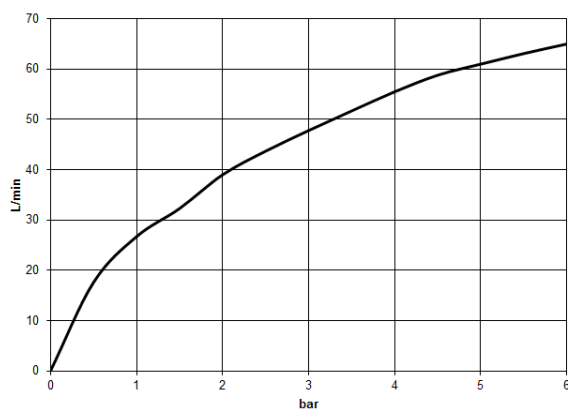

Codes & Standards

DIN 4109

ISO 3822

Scottish Water
Byelaws

UK Water Supply
Regulations

Ü-Zeichen



MEM Bath spout without diverter for free-standing assembly - Brushed
Durabrass (23kt Gold)

MEM

13 672 780 Product version from 9/30/2005

Certificates and sustainability

WRAS_2005	LGA_18	WRAS_250602
-----------	--------	-------------

MEM Bath spout without diverter for free-standing assembly - Brushed Durabrass (23kt Gold)

MEM

13 672 780 Product version from 9/30/2005

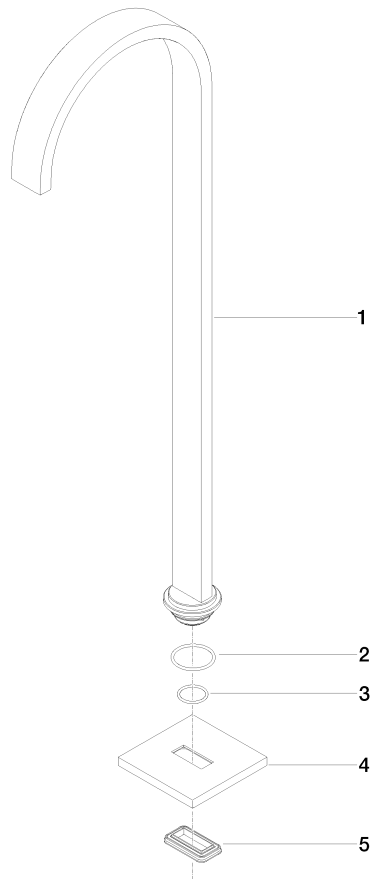

Spare parts list

No.	Item Number	Name	Quantity used	Delivery time
3	09 14 10 018 90	seal	1.00	2
1	04 28 22 183 00-28	spout	1.00	20
4	09 27 78 022-28	rosette	1.00	20
5	09 14 03 106 90	seal	1.00	2
2	09 14 10 084 90	seal	1.00	2