

LISSÉ Bath spout for wall mounting - Brushed Dark Platinum

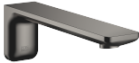





LISSÉ

13 801 845

Product version from 3/9/2016



- 210mm projection
- circular normal flow
- hole diameter 37 mm
- 1/2" connection
- plug-link mounting
- max. flow 21.5 l/min at 3 bar flow pressure
- WRAS

	Brushed Dark Platinum	13 801 845-99
	Chrome	13 801 845-00
	Brushed Platinum	13 801 845-06
	Dark Chrome	13 801 845-19
	Brushed Light Gold	13 801 845-27
	Matte Black	13 801 845-33
	Brushed Chrome	13 801 845-93

Recommended miscellaneous



- Concealed wall elbow -

35 085 970 90

 - min. recess depth 90 mm
 - max. recess depth 163 mm

mm [inches]

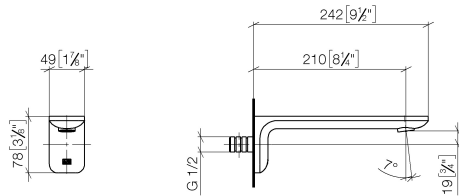

Flow rate chart



Codes & Standards

DIN 4109

ISO 3822

Ü-Zeichen



LISSE Bath spout for wall mounting - Brushed Dark Platinum

LISSE

13 801 845 Product version from 3/9/2016

Certificates and sustainability

LGA_29

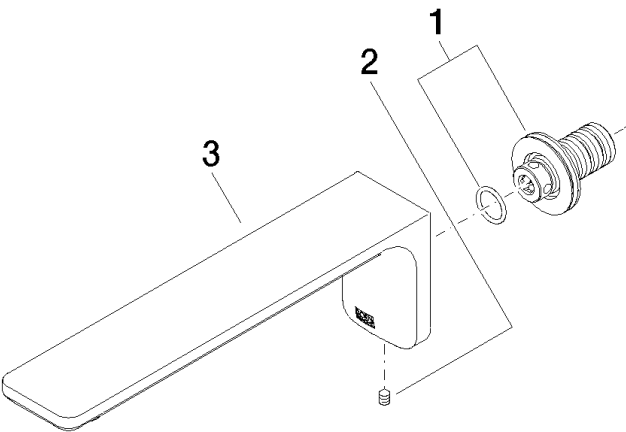

Spare parts list

No.	Item Number	Name	Quantity used	Delivery time
2	90 31 11 004 00 90	pin	1.00	2
1	90 24 03 108 00 90	nipple set	1.00	2
3	90 11 84 014 02-99	spout	1.00	20