

MEM Three-hole basin mixer with pop-up waste - Champagne (22kt Gold)

MEM

20 713 782



- 165mm projection
- fixed spout
- rectangular, air-enriched flow
- height of mixer 277 mm
- height up to aerator 170 mm
- hole diameter spout 35 mm
- hole diameter valve 32 mm
- rosette 60 x 60 mm
- 2x screw-in M 10 x 1 pressure hose, leak-tested
- max. flow 8.3 l/min
- lead-free
- This product can help a building meet the requirements of Green Building Rating Systems, e.g. LEED®, BREEAM®, DGNB
- WRAS 2306057

Only suitable for basins with an overflow.

| | | |
|--|--------------------------------|---------------|
|  | Champagne (22kt Gold) | 20 713 782-47 |
|  | Chrome | 20 713 782-00 |
|  | Brushed Platinum | 20 713 782-06 |
|  | Platinum | 20 713 782-08 |
|  | Dark Chrome | 20 713 782-19 |
|  | Brushed Durabronze (23kt Gold) | 20 713 782-28 |
|  | Brushed Champagne (22kt Gold) | 20 713 782-46 |
|  | Brushed Dark Platinum | 20 713 782-99 |

Recommended miscellaneous



- High pressure hoses -**
- 2x 3/8" x 1/2" x 500mm high pressure hose

12 506 970 90

20 713 782

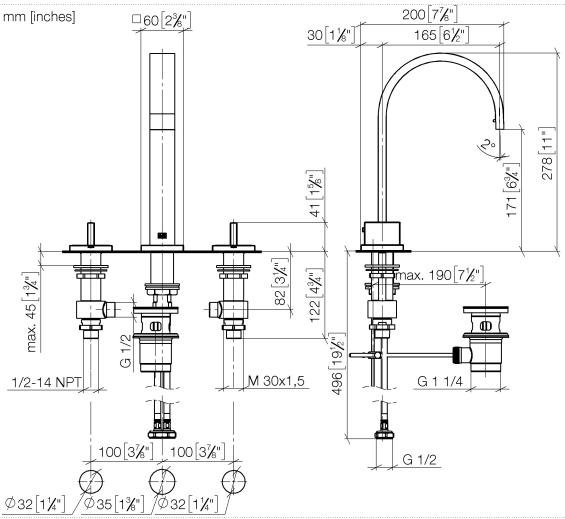

Flow rate chart

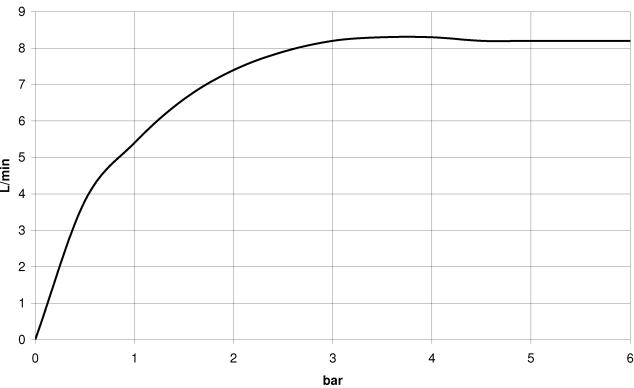

Codes & Standards

| | | | |
|---------------------------|--------------------------------|-----------------------------|------------|
| DIN 4109 | EN 200 | Executive Order no. 1007 | ISO 3822 |
| Scottish Water Byelaws | UK Water Supply Regulations | Ü-Zeichen | VA-Zeichen |



MEM Three-hole basin mixer with pop-up waste - Champagne (22kt Gold)

MEM

20 713 782

Certificates

| | | | |
|--------|-----------|----------|--------|
| ETA_18 | WRAS_2306 | GDV_0400 | LGA_18 |
|--------|-----------|----------|--------|

Product version from 3/10/2014

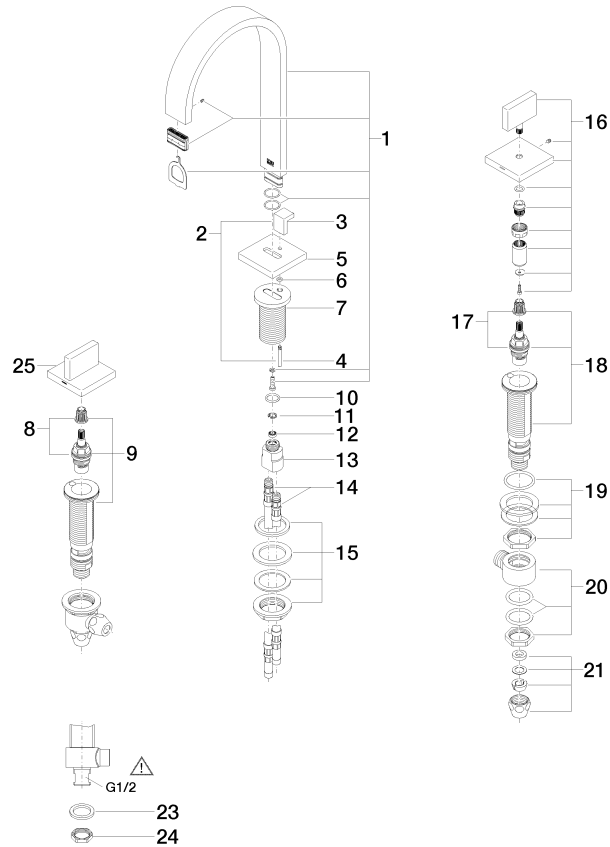

22 ——— Abba/gerber 04.11.01.001.00-9



MEM Three-hole basin mixer with pop-up waste - Champagne (22kt Gold)

MEM

20 713 782

Spare parts list

Product version from 3/10/2014

| No. | Item Number | Name | Quantity used | Delivery time |
|-----|--------------------|-------|---------------|---------------|
| | 90 28 22 158 00-47 | spout | 33 | 30 |